

NOTICE!!

These documents have been scanned!

Do not place un-scanned documents beneath this notice!

Do not remove this notice from this file!

GPO Jacket No. 560-102
Print Order 61540
Rise Business Services, LLC
Job=AZ15 5/22/2019



Box Number= AZ15076



Claim Begin-End: AMC396376-AMC396376

1 Initial Receipt



AZ15076-14 AMC396025-AMC396393

United States Department of the Interior
 Bureau of Land Management
 BUSINESS & SUPPORT SVCS DIV
 ONE N CENTRAL AVE SUITE 800
 PHOENIX, AZ 85004 -4427
 Phone: (602) 417-9200

Receipt

No: 1893334

Transaction #: 1955321		ENTERED INTO COMPUTER <i>5/1/09 RJJ</i>
Date of Transaction: 03/26/2009		
CUSTOMER:	CHARLES CLARK 3565 E JOHN L AVE LOT 11 KINGMAN, AZ 86409-2380 US	

LINE #	QTY	DESCRIPTION	REMARKS	UNIT PRICE	TOTAL
1	1.00	LOCATABLE MINERALS / MINING CLAIMS- NEW, UNADJUD, ONE OR MORE AUTH NOS / NEW MINING CLAIM PROCESSING FEE \$15 CASES: AMC396376/\$15.00		- n/a -	15.00
2	1.00	LOCATABLE MINERALS / MINING CLAIMS- NEW, UNADJUD, ONE OR MORE AUTH NOS / NEW MINING CLAIM LOCATION FEE \$30 CASES: AMC396376/\$30.00		- n/a -	30.00
3	1.00	LOCATABLE MINERALS / MINING CLAIMS- NEW, UNADJUD, ONE OR MORE AUTH NOS / NEW MINING CLM MAINT FEE \$125 (1993 CASES: AMC396376/\$125.00		- n/a -	125.00
TOTAL:					\$170.00

PAYMENT INFORMATION			
1	AMOUNT:	170.00	POSTMARKED: 03/24/2009
	TYPE:	CHECK	RECEIVED: 03/26/2009
	CHECK NO:	50134130335	
	NAME:	CLARK, CHARLES 3565 E JOHN L AVE LOT 11 KINGMAN AZ 86409-2380 US	

REMARKS

This receipt was generated by the automated BLM Collections and Billing System and is a paper representation of a portion of the official electronic record contained therein.

NOTICE!!

These documents have been scanned!

Do not place un-scanned documents beneath this notice!

Do not remove this notice from this file!

GPO Jacket No. 560-102
Print Order 61540
Rise Business Services, LLC
Job=AZ15 5/22/2019



Box Number= AZ15076



Claim Begin-End: AMC396376-AMC396376

2 Correspondence



AZ15076-14

AMC396025-AMC396393

**NO
DOCUMENTS
FOUND**

NO DOCUMENTS FOUND
NO DOCUMENTS FOUND

NOTICE!!

These documents have been scanned!

Do not place un-scanned documents beneath this notice!

Do not remove this notice from this file!

GPO Jacket No. 560-102
Print Order 61540
Rise Business Services, LLC
Job=AZ15 5/22/2019



Box Number= AZ15076



Claim Begin-End: AMC396376-AMC396376

3 Transfers



AZ15076-14

AMC396025-AMC396393

**NO
DOCUMENTS
FOUND**

NO DOCUMENTS FOUND
NO DOCUMENTS FOUND

NOTICE!!

These documents have been scanned!

Do not place un-scanned documents beneath this notice!

Do not remove this notice from this file!

GPO Jacket No. 560-102
Print Order 61540
Rise Business Services, LLC
Job=AZ15 5/22/2019



Box Number= AZ15076



Claim Begin-End: AMC396376-AMC396376

4 Annual Filings



AZ15076-14

AMC396025-AMC396393

UNITED STATES
DEPARTMENT OF THE INTERIOR
BUREAU OF LAND MANAGEMENT

MAINTENANCE FEE WAIVER CERTIFICATION

SEE INSTRUCTIONS ON PAGE 2

119
JML

396376

FORM APPROVED
OMB NO. 1004-0114
Expires: January 31, 2020

- This small miner waiver is filed for the assessment year beginning on September 1, ~~2018~~ and ending on September 1, ~~2019~~.
- The undersigned and all related parties owned ten or fewer mining claims, mill, or tunnel sites located and maintained on Federal lands in the United States of America on September 1, ~~2018~~.
- The undersigned have performed the assessment work required by law for each mining claim listed prior to filing this waiver and understand that by filing this form, the undersigned must file an affidavit of assessment work with the Bureau of Land Management (BLM) by the December 30th following the filing of this waiver.
- The undersigned understand that if the assessment work obligation has not yet come due under 30 U.S.C. 28 (for those claims in their first assessment year only), a notice of intent to hold reciting this condition must be recorded by the December 30th following the filing of this waiver.
- The undersigned understand that mill and tunnel sites may also be listed on this waiver and be waived from payment of the maintenance fee, and that a notice of intent to hold for these sites is required to be filed with the BLM by the December 30th following the filing of this waiver.
- The undersigned understand and acknowledge that pursuant to 43 U.S.C. 1212 and 18 U.S.C. 1001, the filing or recording of a false, fictitious, or fraudulent document with the BLM may result in a fine of up to \$250,000, a prison term not to exceed five years, or both.
- The mining claims, mill or tunnel sites for which this waiver from payment of the maintenance fees is requested are:

CLAIM OR SITE NAME	BLM RECORDATION SERIAL NUMBER
1. Boulder Creek Lode mine ✓	AMC396376
2.	
3.	
4.	
5.	
6.	
7.	
8.	
9.	
10.	

RECEIVED
BLM AT STATE OFFICE
2019 AUG - 6 A 8:25
PHOENIX, ARIZONA

The owner(s) (claimants) of the above mining claims and sites are:

Charles Clark
(Owner's Name - Please Print)
1137 Topeka St
(Owner's Mailing Address)

Charles Clark
(Owner's Signature)
Kingman AZ 86401
(City) (State) (Zip Code)

(Owner's Name - Please Print)

(Owner's Mailing Address)

(Owner's Signature)

(City) (State) (Zip Code)

(Owner's Name - Please Print)

(Owner's Mailing Address)

(Owner's Signature)

(City) (State) (Zip Code)

(Owner's Name - Please Print)

(Owner's Mailing Address)

(Owner's Signature)

(City) (State) (Zip Code)

(Continued on page 2)

ENTERED
BY: [Signature]

[Signature]

(Owner's Name - Please Print)	(Owner's Signature)
(Owner's Mailing Address)	(City) (State) (Zip Code)
(Owner's Name - Please Print)	(Owner's Signature)
(Owner's Mailing Address)	(City) (State) (Zip Code)
(Owner's Name - Please Print)	(Owner's Signature)
(Owner's Mailing Address)	(City) (State) (Zip Code)
(Owner's Name - Please Print)	(Owner's Signature)
(Owner's Mailing Address)	(City) (State) (Zip Code)

18 U.S.C. 1001 and 43 U.S.C. 1212 make it a crime for any person knowingly and willfully to make to any department or agency of the United States any false, fictitious or fraudulent statements or representations as to any matter within its jurisdiction.

INSTRUCTIONS

1. This certification is made under the provisions of 43 U.S.C. § 1744 and 30 U.S.C. §28-28k and the regulations thereunder (43 CFR Part 3830).
2. The claimant(s) must fill in the dates in paragraph 1 for the beginning and ending of the assessment year for which this waiver is sought.
3. The claimant(s) must fill in the date in paragraph 2 for the beginning of the assessment year for which this waiver is sought.
4. All claim and site names and BLM serial numbers must be listed for the mining claims, mill sites, and tunnel sites for which the waiver is sought.
5. All owners of the mining claims, mill sites, and tunnel sites and their addresses must be given.
6. This waiver form must be signed by all the claimants or their designated agent, in original form. If an agent is designated, a notarized designation of agent, signed by all of the claimants with proper address given, must be submitted with this waiver.
7. This form must be filed no later than September 1st for the upcoming assessment year in the BLM State Office where the mining claims or sites are recorded, or the waiver cannot be granted by the BLM. (Example: To obtain a waiver for the assessment year 2012, which begins on September 1, 2011, you must qualify for and file for a waiver no later than September 1, 2011, in the proper BLM State Office.)
8. For all mining claims which require assessment work, you must record an affidavit of labor on or before the December 30th immediately following the filing of this waiver. For all other mining claims or sites waived, you must record a notice of intent to hold on or before the December 30th immediately following the filing of this waiver.
9. Mill and tunnel sites may also be listed on this waiver and be waived from payment of the maintenance fee. A notice of intent to hold for these sites is required to be filed by the December 30th following the filing of this waiver.

FOR OFFICIAL USE ONLY

AMC 396376

When Recorded Return Document to:

Charles Clark
1137 Topeka St
Kingman, AZ
86401

FEE# 2018059488

OFFICIAL RECORDS
OF MOHAVE COUNTY
KRISTI BLAIR,
COUNTY RECORDER



12/03/2018 12:44 PM Fee: \$15.00

PAGE: 1 of 2

Check here if this is a change of address.

Telephone: 928-279-5939

E-mail address: clarkmines2@gmail.com

AFFIDAVIT OF PERFORMANCE OF ANNUAL WORK

1. State of Arizona, County of Mohave ss:

2. I (Name) Charles Clark

3. Reside at (Address) 1137 Topeka St

City Kingman County Mohave

RECEIVED
BLM AZ STATE OFFICE
2018 DEC -7 P 3:01
PHOENIX, ARIZONA

BLM
Date
Stamp

State AZ zip 86401 being duly sworn, depose and say that I am a citizen of the United States, more than eighteen years of age, and that all of the facts set forth in this affidavit, subject to the provisions and penalties of 18 U.S.C. 1001 pertaining to the filing of false, fictitious, or fraudulent statements with the United States, are true and correct according to the best of my knowledge, information and belief.

4. Owner's name and address (If not shown in Items 1-3 above).

5. That I am personally acquainted with the mining claim(s). The work and improvements were made by and at the expense of the owner(s) of said claim(s). Said contiguous group of claims, listed on this document, are situated in the

McConnico (optional) Mining District; Mohave County, Arizona.

Line No.	AMC NUMBER	CLAIM/SITE NAME	COUNTY RECORDER DATA (If available)	TWP	RNG	SEC
1	396376	Boulder Creek		20N	17W	10
2						
3						
4						
5						
6						

Form: MCF108
Revised July 2014
Page 1 of 2

ENTERED
FEB 07 2019
BY: fm

4328912

SENT EMAIL
FOR ADDC # 12/18/18 RAM

RECEIVED
BLM-AZ STATE OFFICE
PHOENIX, ARIZONA
MID DEC - 7 P 3 01

BLM
Date
Stamp

7					
8					
9					
10					

6. That between the dates starting at 12 o'clock noon on September 1, 20 17 and ending at 12 o'clock noon on September 1, 20 18 at least \$ 500 dollars worth of work and improvements were done and performed upon said claim(s) or upon one or more of a contiguous group of claims for the benefit of all, wholly or partly outside of a contiguous group of claims for the benefit of all, not including the location work.

7. That the following persons were employed to perform the work and improvements described herein: Self

8. That the work and improvements performed were: dug additional 10ft of shaft end timbered and reworked access road to mine to accomodate drainages for monsoon rains.

9 Dated: 12-3-18 Signature: Charles Clark

SUBSCRIBED AND SWORN TO before me, a Notary Public, this 3 day of Dec, 2018

By: Charles Clark

Notary Public Ila M. Buchanan

My Commission Expires 3-10-2021

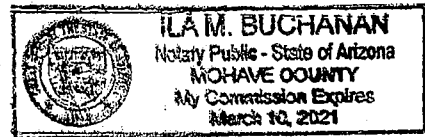

Bureau of Land Management
Arizona State Office
www.blm.gov/az

No. of Claims: _____ x \$10 = _____
 Check No.: _____ Init. _____
 Receipt No.: _____
 For BLM Use Only

Form: MCF108
Revised July 2014
Page 2 of 2

Charles Clark
1137 Topeka St
Kingman, AZ
86401
Amc396376

LAS VEGAS NV 890

03 DEC 2018 PM 5 L



Bureau of Land Management
Mine Claim Filings
One North Central Ave, Ste 800
Phoenix, Arizona
85004-4427

PHOENIX, ARIZONA

2018 DEC -7 P 3:01

RECEIVED
BLM AZ STATE OFFICE

85004-442700



United States Department of the Interior
Bureau of Land Management
 DIV OF LANDS, MINRLS & ENERGY
 ONE N CENTRAL AVE
 PHOENIX, AZ 85004 -4427
 Phone: 602-417-9200

Receipt

No: 4328912

Transaction #: 4445562	
Date of Transaction: 12/07/2018	
CUSTOMER:	
CHARLES CLARK 1137 TOPEKA ST KINGMAN, AZ 86401-6271 US	

LINE #	QTY	DESCRIPTION	REMARKS	UNIT PRICE	TOTAL
1	1.00	LOCATABLE MINERALS / MINING CLAIMS- NOT NEW-UNADJUD, ONE AUTH NO. ONLY / MINING CLAIM MONEY RECEIVED CASES: AMC396376/\$10.00	POL 2018/1	- n/a -	10.00
TOTAL:					\$10.00

PAYMENT INFORMATION			
1	AMOUNT:	10.00	POSTMARKED: N/A
	TYPE:	CHECK	RECEIVED: 12/07/2018
	CHECK NO:	51343201675	
	NAME:	CLARK, CHARLES 1137 TOPEKA ST KINGMAN AZ 86401-6271 US	

REMARKS
THERE HAS BEEN A FEE INCREASE/ PLEASE SEE ENCLOSED FLYER/ THANK YOU

This receipt was generated by the automated BLM Collections and Billing System and is a paper representation of a portion of the official electronic record contained therein.

*USED THIS AND RECEIPT #4366782 (#5)
FOR \$15 PROCESSING FEE ON AMC396376 RM*

United States Department of the Interior
Bureau of Land Management
 DIV OF LANDS, MINRLS & ENERGY
 ONE N CENTRAL AVE
 PHOENIX, AZ 85004 -4427
 Phone: 602-417-9200

Receipt

No:

4366782

Transaction #: 4484032	
Date of Transaction: 02/05/2019	
CUSTOMER:	
CHARLES CLARK 1137 TOPEKA ST KINGMAN, AZ 86401-6271 US	

LINE #	QTY	DESCRIPTION	REMARKS	UNIT PRICE	TOTAL
1	1.00	LOCATABLE MINERALS / MINING CLAIMS-NOT NEW-UNADJUD, ONE AUTH NO. ONLY / MINING CLAIM MONEY RECEIVED CASES: AMC396376/\$5.00	ADDITIONAL POL FEES	- n/a -	5.00
TOTAL:					\$5.00

PAYMENT INFORMATION				
1	AMOUNT:	5.00	POSTMARKED:	N/A
	TYPE:	CHECK	RECEIVED:	01/28/2019
	CHECK NO:	51343202215		
	NAME:	CLARK, CHARLES 1137 TOPEKA ST KINGMAN AZ 86401-6271 US		

REMARKS

This receipt was generated by the automated BLM Collections and Billing System and is a paper representation of a portion of the official electronic record contained therein.

*USED THIS AND RECEIPT # 4328912 (\$10)
 FOR \$15 PROCESSING FEE ON 2018 POL FOR
 AMC 396376. RM*

Login ID6222

Entry Date02/07/2019

Total Amount\$5.00

Original Order Items

Line	Order#	AuthNos	TransDate	Action	Amount	CostCtr	R Org	BPD Year	Fund	FunctArea	WBS	Receipt Reference	CBS Bill#	Type	OrderItem
1	4484032	AMC396376 ▼	02/05/2019	MINING CLAIM MONEY RECEIVED	\$5.00	LLAZ920000	LLAZ920000	2019	XXXL6500DP	L01130000.000000				C	9015065

Order Items To Be Generated for Transfer

Line	Order#	AuthNos	TransDate	Action	Amount	CostCtr	R Org	BPD Year	Fund	FunctArea	WBS	Receipt Reference	CBS Bill#	Type	OrderItem
1	4484032	AMC396376 ▼	2/7/2019	MINING CLAIM MONEY RECEIVED	\$-5.00	LLAZ920000	LLAZ920000	2019	XXXL6500DP	L01130000.000000				T	0
2	4484032		2/7/2019	NONREFUNDABLE PROCESSING FEE	\$5.00	LLAZ920000	LLAZ920000	2019	19XL1109ML	L19300000.RB0000				T	0

Login ID6222

Entry Date02/08/2019

Total Amount\$10.00

Original Order Items

Line	Order#	AuthNos	TransDate	Action	Amount	CostCtr	R Org	BPD Year	Fund	FunctArea	WBS	Receipt Reference	CBS Bill#	Type	OrderItem
1	4445562	AMC396376 ▾	12/07/2018	MINING CLAIM MONEY RECEIVED	\$10.00	LLAZ920000	LLAZ920000	2019	XXXL6500DP	L01130000.000000				C	8953546

Order Items To Be Generated for Transfer

Line	Order#	AuthNos	TransDate	Action	Amount	CostCtr	R Org	BPD Year	Fund	FunctArea	WBS	Receipt Reference	CBS Bill#	Type	OrderItem
1	4445562	AMC396376 ▾	2/8/2019	MINING CLAIM MONEY RECEIVED	\$-10.00	LLAZ920000	LLAZ920000	2019	XXXL6500DP	L01130000.000000				T	0
2	4445562	▾	2/8/2019	NONREFUNDABLE PROCESSING FEE	\$10.00	LLAZ920000	LLAZ920000	2019	19XL1109ML	L19300000.RB0000				T	0

Additional Processing Fees Required

2 messages

Mattson, Robert <rmattson@blm.gov>
To: clarkmines2@gmail.com

Tue, Dec 18, 2018 at 10:16 AM

Due to a processing fee increase effective October 1, 2018, we did not receive sufficient fees with your annual filings. Please mail in the additional amounts per claim or call our public room at 602-417-9200. Please include AMC numbers and claim names and let us know it is to pay additional fees for your Affidavit of Labor or Notice of Intent to Hold. These fees are now **15 dollars** per claim and you owe an additional **5 dollars** per claim. If you have already submitted the additional amount please disregard this email.

Robert Mattson
BLM, Arizona State Office
Legal Instruments Examiner
9200 Lands, Minerals & Energy

Dawna C <clarkmines2@gmail.com>
To: "Mattson, Robert" <rmattson@blm.gov>

Tue, Dec 18, 2018 at 11:58 PM

Hello,

Thanks for letting us know that. I had wondered why we havent gotten the filing notice back and now i know why. We had no idea the Small Miners Filing Fee had increased. We have sent a USPS Money Order in the amount of the extra five dollars to cover the increased fee Wednesday morning the 19th. I have also included a copy of this email message along with a note of the Claim Information the USPS Money Order is for. Id say look for the envelope by Monday or Tuesday of this coming week if not before then.

Thanks again for contacting us on this.

Charles Clark
Mine Claim Holder
AMC396376
Boulder Creek Lode
McConnico Mining District
Mohave County, Arizona

```
<table style="border-top: 1px solid #D3D4DE;">
  <tr>
    <td style="width: 55px; padding-top: 13px;"><a
href="http://www.avg.com/email-signature?utm_medium=email&utm_source=link&utm_campaign=sig-email&utm_content=webmail"
target="_blank"></a></td>
```

RECEIVED
BLM AZ STATE OFFICE
2019 JAN 28 P 1:11
PHOENIX, ARIZONA

#4346782

<td style="width: 470px; padding-top: 12px; color: #41424e; font-size: 13px; font-family: Arial, Helvetica, sans-serif; line-height: 18px;">Virus-free. www.avg.com

</td>
</tr>
</table></div>

On 12/18/18, Mattson, Robert <rmattson@blm.gov> wrote:

- > Due to a processing fee increase effective October 1, 2018, we did not
- > receive sufficient fees with your annual filings. Please mail in the
- > additional amounts per claim or call our public room at 602-417-9200.
- > Please include AMC numbers and claim names and let us know it is to pay
- > additional fees for your Affidavit of Labor or Notice of Intent to Hold.
- > **These fees are now *15 dollars* per claim and you owe an additional *5**
- > **dollars* per claim. If you have already submitted the additional amount**

[Quoted text hidden]

Hello,

I recieved this email enclosed that I owe an extra 5 dollars in addition to the Annual Work Assessment fee so enclosed is the extra five dollars I may owe for the Mine Claim Filing of AMC 396376, The Boulder Creek Claim.

Charles Clark

RECEIVED
BLM AZ STATE OFFICE
2019 JAN 28 P 1:11
PHOENIX, ARIZONA

Charles Clark
1137 Topeka St
Kingman AZ
86401

AMC396376

Bureau of Land Management
One North Central Ave., Ste 800
Phoenix, Arizona
85004-4427

LAS VEGAS NV 890



PHOENIX, ARIZONA

2019 JAN 28 P 1:11

RECEIVED
BLM AZ STATE OFFICE

85004-4427
Mine Filing Dept.



United States Department of the Interior
Bureau of Land Management
 DIV OF LANDS, MINRLS & ENERGY
 ONE N CENTRAL AVE
 PHOENIX, AZ 85004 -4427
 Phone: 602-417-9200

Receipt

No: 4366782

Transaction #: 4484032	
Date of Transaction: 02/05/2019	
CUSTOMER:	
CHARLES CLARK 1137 TOPEKA ST KINGMAN, AZ 86401-6271 US	

LINE #	QTY	DESCRIPTION	REMARKS	UNIT PRICE	TOTAL
1	1.00	LOCATABLE MINERALS / MINING CLAIMS-NOT NEW-UNADJUD, ONE AUTH NO. ONLY / MINING CLAIM MONEY RECEIVED CASES: AMC396376/\$5.00	ADDITIONAL POL FEES	- n/a -	5.00
TOTAL:					\$5.00

PAYMENT INFORMATION			
1	AMOUNT:	5.00	POSTMARKED: N/A
	TYPE:	CHECK	RECEIVED: 01/28/2019
	CHECK NO:	51343202215	
	NAME:	CLARK, CHARLES 1137 TOPEKA ST KINGMAN AZ 86401-6271 US	

REMARKS

This receipt was generated by the automated BLM Collections and Billing System and is a paper representation of a portion of the official electronic record contained therein.

AMC396376

152 JMC

Form 3830-2
(January 2017)

UNITED STATES
DEPARTMENT OF THE INTERIOR
BUREAU OF LAND MANAGEMENT
MAINTENANCE FEE WAIVER CERTIFICATION

FORM APPROVED
OMB NO. 1004-0114
Expires: January 31, 2020

SEE INSTRUCTIONS ON PAGE 2

152

1. This small miner waiver is filed for the assessment year beginning on September 1, 2017 and ending on September 1, 2018.
2. The undersigned and all related parties owned ten or fewer mining claims, mill, or tunnel sites located and maintained on Federal lands in the United States of America on September 1, 2018.
3. The undersigned have performed the assessment work required by law for each mining claim listed prior to filing this waiver and understand that by filing this form, the undersigned must file an affidavit of assessment work with the Bureau of Land Management (BLM) by the December 30th following the filing of this waiver.
4. The undersigned understand that if the assessment work obligation has not yet come due under 30 U.S.C. 28 (for those claims in their first assessment year only), a notice of intent to hold reciting this condition must be recorded by the December 30th following the filing of this waiver.
5. The undersigned understand that mill and tunnel sites may also be listed on this waiver and be waived from payment of the maintenance fee, and that a notice of intent to hold for these sites is required to be filed with the BLM by the December 30th following the filing of this waiver.
6. The undersigned understand and acknowledge that pursuant to 43 U.S.C. 1212 and 18 U.S.C. 1001, the filing or recording of a false, fictitious, or fraudulent document with the BLM may result in a fine of up to \$250,000, a prison term not to exceed five years, or both.
7. The mining claims, mill or tunnel sites for which this waiver from payment of the maintenance fees is requested are:

CLAIM OR SITE NAME	BLM RECORDATION SERIAL NUMBER
1. Boulder Creek Lode	AMC396376
2.	
3.	
4.	
5.	
6.	
7.	
8.	
9.	
10.	

RECEIVED
BLM AZ STATE OFFICE
2018 AUG -6 P 2:30
PHOENIX, ARIZONA

The owner(s) (claimants) of the above mining claims and sites are:

Charles Clark
(Owner's Name - Please Print)
1137 Topeka St
(Owner's Mailing Address)

Charles Clark
(Owner's Signature)
Kingman AZ 86401
(City) (State) (Zip Code)

(Owner's Name - Please Print)

(Owner's Mailing Address)

(Owner's Signature)

(City) (State) (Zip Code)

(Owner's Name - Please Print)

(Owner's Mailing Address)

(Owner's Signature)

(City) (State) (Zip Code)

(Owner's Name - Please Print)

(Owner's Mailing Address)

(Owner's Signature)

(City) (State) (Zip Code)

AC 483
ENTERED SEP 04 2018
(City)

(Continued on page 2)

NW/PB

(Owner's Name - Please Print)

(Owner's Signature)

(Owner's Mailing Address)

(City)

(State)

(Zip Code)

(Owner's Name - Please Print)

(Owner's Signature)

(Owner's Mailing Address)

(City)

(State)

(Zip Code)

(Owner's Name - Please Print)

(Owner's Signature)

(Owner's Mailing Address)

(City)

(State)

(Zip Code)

(Owner's Name - Please Print)

(Owner's Signature)

(Owner's Mailing Address)

(City)

(State)

(Zip Code)

18 U.S.C. 1001 and 43 U.S.C. 1212 make it a crime for any person knowingly and willfully to make to any department or agency of the United States any false, fictitious or fraudulent statements or representations as to any matter within its jurisdiction.

INSTRUCTIONS

1. This certification is made under the provisions of 43 U.S.C. § 1744 and 30 U.S.C. §28-28k and the regulations thereunder (43 CFR Part 3830).
2. The claimant(s) must fill in the dates in paragraph 1 for the beginning and ending of the assessment year for which this waiver is sought.
3. The claimant(s) must fill in the date in paragraph 2 for the beginning of the assessment year for which this waiver is sought.
4. All claim and site names and BLM serial numbers must be listed for the mining claims, mill sites, and tunnel sites for which the waiver is sought.
5. All owners of the mining claims, mill sites, and tunnel sites and their addresses must be given.
6. This waiver form must be signed by all the claimants or their designated agent, in original form. If an agent is designated, a notarized designation of agent, signed by all of the claimants with proper address given, must be submitted with this waiver.
7. This form must be filed no later than September 1st for the upcoming assessment year in the BLM State Office where the mining claims or sites are recorded, or the waiver cannot be granted by the BLM. (Example: To obtain a waiver for the assessment year 2012, which begins on September 1, 2011, you must qualify for and file for a waiver no later than September 1, 2011, in the proper BLM State Office.)
8. For all mining claims which require assessment work, you must record an affidavit of labor on or before the December 30th immediately following the filing of this waiver. For all other mining claims or sites waived, you must record a notice of intent to hold on or before the December 30th immediately following the filing of this waiver.
9. Mill and tunnel sites may also be listed on this waiver and be waived from payment of the maintenance fee. A notice of intent to hold for these sites is required to be filed by the December 30th following the filing of this waiver.

FOR OFFICIAL USE ONLY

ENTERED SEP 04 2018

Charles Clark
1137 Topelca St
Kingman AZ
86401

AMC396376

RECEIVED
BLM AZ STATE OFFICE

2018 AUG -6 P 2:30

PHOENIX, ARIZONA

LAS VEGAS NV 890
01 AUG 2018 PM 3 L



Bureau of Land Management
Mining Claim Filings
One North Central Ave., Ste 800
Phoenix, Arizona
85004-4427

85004-442700



Amc 396376

2

When Recorded Return Document to:

Charles Clark
1137 Topeka St
Kingman AZ
86401

Check here if this is a change of address.

Telephone: 928-279-5939

E-mail address: _____

FEE# 2017058154

OFFICIAL RECORDS
OF MOHAVE COUNTY
KRISTI BLAIR,
COUNTY RECORDER



12/01/2017 12:57 PM Fee: \$15.00

PAGE: 1 of 2

AFFIDAVIT OF PERFORMANCE OF ANNUAL WORK

1. State of Arizona, County of Mohave ss:

2. I (Name) Charles Clark

3. Reside at (Address) 1137 Topeka St

City Kingman County Mohave

State AZ Zip 86401 being duly sworn, depose and say that I am a citizen of the United States, more than eighteen years of age, and that all of the facts set forth in this affidavit, subject to the provisions and penalties of 18 U.S.C. 1001 pertaining to the filing of false, fictitious, or fraudulent statements with the United States, are true and correct according to the best of my knowledge, information and belief.

4. Owner's name and address (if not shown in Items 1-3 above) _____

5. That I am personally acquainted with the mining claim(s). The work and improvements were made by and at the expense of the owner(s) of said claim(s). Said contiguous group of claims, listed on this document, are situated in the

McCannico (optional) Mining District; Mohave County, Arizona.

Line No.	AMC NUMBER	CLAIM/SITE NAME	COUNTY RECORDER DATA (If available)	TWP	RNG	SEC
1	396376	Boulder Creek	2017058154	20N	17W	10
2						
3						
4						
5						
6						

RECEIVED
BLM ARIZONA STATE OFFICE
2017 DEC -7 P 2:54
PHOENIX, ARIZONA

Form: MCF108
Revised July 2014
Page 1 of 2

ENTERED
DEC 14 2017
BY: EBB

BLM
Date
Stamp

RECEIVED
2017 DEC - 7 P 2:54
PHOENIX, ARIZONA

7					
8					
9					
10					

6. That between the dates starting at 12 o'clock noon on September 1, 20 16 and ending at 12 o'clock noon on September 1, 20 17 at least \$ 200 dollars worth of work and improvements were done and performed upon said claim(s) or upon one or more of a contiguous group of claims for the benefit of all, wholly or partly outside of a contiguous group of claims for the benefit of all, not including the location work.

7. That the following persons were employed to perform the work and improvements described herein: SELF

8. That the work and improvements performed were: provided drainages beside access road to accommodate monsoon flood waters.

9. Dated: 12/07/17 Signature: Charles Clark

SUBSCRIBED AND SWORN TO before me, a Notary Public, this 1st day of December 20 17

By: Charles Clark

Notary Public Elyssa Rae Anderson *Elyssa Rae Anderson*

My Commission Expires 08/18/2018

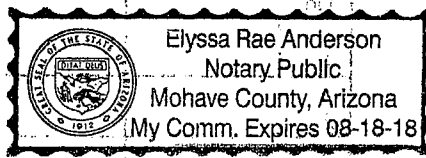

Bureau of Land Management
Arizona State Office
www.blm.gov/az

No. of Claims: _____ x \$10 = _____
 Check No.: _____ Init. *JAC*
 Receipt No.: 4039036
 For BLM Use Only

Charles Clark
1137 Topelca St
Kingman AZ
86401

AMC396396

RECEIVED
BLM AZ STATE OFFICE

2017 DEC -7 P 2:54

PHOENIX, ARIZONA

LAS VEGAS NV 890

04 DEC 2017 PM 2 L



Bureau of Land Management
Mining Claim filings
One North Central Ave., Ste. 800
Phoenix, Arizona 85004-4427

85004-442700



**United States Department of the Interior
Bureau of Land Management**
DIV OF LANDS, MINRLS & ENERGY
ONE N CENTRAL AVE
PHOENIX, AZ 85004 -4427
Phone: 602-417-9200

Receipt

No: 4039036

Transaction #: 4150231	
Date of Transaction: 12/11/2017	
CUSTOMER:	
CHARLES CLARK 1137 TOPEKA ST KINGMAN, AZ 86401-6271 US	

LINE #	QTY	DESCRIPTION	REMARKS	UNIT PRICE	TOTAL
1	1.00	LOCATABLE MINERALS / MINING CLAIMS- NOT NEW-UNADJUD, ONE AUTH NO. ONLY / MINING CLAIM MONEY RECEIVED CASES: AMC396376/\$10.00	POL 2017/1	- n/a -	10.00
TOTAL:					\$10.00

PAYMENT INFORMATION			
1	AMOUNT:	10.00	POSTMARKED: N/A
	TYPE:	CHECK	RECEIVED: 12/07/2017
	CHECK NO:	50709019803	
	NAME:	CLARK, CHARLES 1137 TOPEKA ST KINGMAN AZ 86401-6271 US	

REMARKS

This receipt was generated by the automated BLM Collections and Billing System and is a paper representation of a portion of the official electronic record contained therein.

396376

UNITED STATES
DEPARTMENT OF THE INTERIOR
BUREAU OF LAND MANAGEMENT
MAINTENANCE FEE WAIVER CERTIFICATION

121

FORM APPROVED
OMB NO. 1004-0114
Expires: January 31, 2020

SEE INSTRUCTIONS ON PAGE 2

1. This small miner waiver is filed for the assessment year beginning on September 1, ~~2016~~²⁰¹⁷ and ending on September 1, ~~2017~~²⁰¹⁸.
2. The undersigned and all related parties own ten or fewer mining claims, mill, or tunnel sites located and maintained on Federal lands in the United States of America on September 1, ~~2016~~²⁰¹⁷.
3. The undersigned have performed the assessment work required by law for each mining claim listed prior to filing this waiver and understand that by filing this form, the undersigned must file an affidavit of assessment work with the Bureau of Land Management (BLM) by the December 30th following the filing of this waiver.
4. The undersigned understand that if the assessment work obligation has not yet come due under 30 U.S.C. 28 (for those claims in their first assessment year only), a notice of intent to hold reciting this condition must be recorded by the December 30th following the filing of this waiver.
5. The undersigned understand that mill and tunnel sites may also be listed on this waiver and be waived from payment of the maintenance fee, and that a notice of intent to hold for these sites is required to be filed with the BLM by the December 30th following the filing of this waiver.
6. The undersigned understand and acknowledge that pursuant to 43 U.S.C. 1212 and 18 U.S.C. 1001, the filing or recording of a false, fictitious, or fraudulent document with the BLM may result in a fine of up to \$250,000, a prison term not to exceed five years, or both.
7. The mining claims, mill or tunnel sites for which this waiver from payment of the maintenance fees is requested are:

CLAIM OR SITE NAME	BLM RECORDATION SERIAL NUMBER
1. Boulder Creek Lode Mine ✓	AMC396376
2.	
3.	
4.	
5.	
6.	
7.	
8.	
9.	
10.	

RECEIVED
BLM ASSESSMENT SERVICE
2017 AUG -4 P 3:10
PHOENIX, ARIZONA

The owner(s) (claimants) of the above mining claims and sites are:

Charles Clark
(Owner's Name - Please Print)

Charles Clark
(Owner's Signature)

1137 Topeka Street
(Owner's Mailing Address)

Kingman **AZ** **86401**
(City) (State) (Zip Code)

(Owner's Name - Please Print) (Owner's Signature)

(Owner's Mailing Address) (City) (State) (Zip Code)

(Owner's Name - Please Print) (Owner's Signature)

(Owner's Mailing Address) (City) (State) (Zip Code)

(Owner's Name - Please Print) (Owner's Signature)

(Owner's Mailing Address) (City) (State) (Zip Code)

483
ENTERED
AUG 31 2017
BY: [Signature]

(Continued on page 2)

NW
[Signature]

_____ (Owner's Name - Please Print)	_____ (Owner's Signature)		
_____ (Owner's Mailing Address)	_____ (City)	_____ (State)	_____ (Zip Code)

_____ (Owner's Name - Please Print)	_____ (Owner's Signature)		
_____ (Owner's Mailing Address)	_____ (City)	_____ (State)	_____ (Zip Code)

_____ (Owner's Name - Please Print)	_____ (Owner's Signature)		
_____ (Owner's Mailing Address)	_____ (City)	_____ (State)	_____ (Zip Code)

_____ (Owner's Name - Please Print)	_____ (Owner's Signature)		
_____ (Owner's Mailing Address)	_____ (City)	_____ (State)	_____ (Zip Code)

18 U.S.C. 1001 and 43 U.S.C. 1212 make it a crime for any person knowingly and willfully to make to any department or agency of the United States any false, fictitious or fraudulent statements or representations as to any matter within its jurisdiction.

INSTRUCTIONS

1. This certification is made under the provisions of 43 U.S.C. § 1744 and 30 U.S.C. §28-28k and the regulations thereunder (43 CFR Part 3830).
2. The claimant(s) must fill in the dates in paragraph 1 for the beginning and ending of the assessment year for which this waiver is sought.
3. The claimant(s) must fill in the date in paragraph 2 for the beginning of the assessment year for which this waiver is sought.
4. All claim and site names and BLM serial numbers must be listed for the mining claims, mill sites, and tunnel sites for which the waiver is sought.
5. All owners of the mining claims, mill sites, and tunnel sites and their addresses must be given.
6. This waiver form must be signed by all the claimants or their designated agent, in original form. If an agent is designated, a notarized designation of agent, signed by all of the claimants with proper address given, must be submitted with this waiver.
7. This form must be filed no later than September 1st for the upcoming assessment year in the BLM State Office where the mining claims or sites are recorded, or the waiver cannot be granted by the BLM. (Example: To obtain a waiver for the assessment year 2012, which begins on September 1, 2011, you must qualify for and file for a waiver no later than September 1, 2011, in the proper BLM State Office.)
8. For all mining claims which require assessment work, you must record an affidavit of labor on or before the December 30th immediately following the filing of this waiver. For all other mining claims or sites waived, you must record a notice of intent to hold on or before the December 30th immediately following the filing of this waiver.
9. Mill and tunnel sites may also be listed on this waiver and be waived from payment of the maintenance fee. A notice of intent to hold for these sites is required to be filed by the December 30th following the filing of this waiver.

FOR OFFICIAL USE ONLY

RECEIVED
BLM ARIZONA STATE OFFICE
2017 AUG 4 P 3:10
PHOENIX, ARIZONA

Charles Clark
1137 Topeka St
Kingman AZ
86401
AMC396376

LAS VEGAS NV 890

01 AUG 2017 PM 2 L



Bureau of Land Management
Mine Claim Filings
One North Central Ave Ste 800
Phoenix, Arizona 85004-4427

PHOENIX, ARIZONA

2017 AUG -4 P 3: 10

RECEIVED
BLM AZ STATE OFFICE

When Recorded Return Document to:

Charles Clark
1137 Topeka St
Kingman AZ 86401

396376

FEE# 2016054494

Check here is this is a change of address.

Telephone: 928-279-5939

E-mail address: _____

OFFICIAL RECORDS
OF MOHAVE COUNTY
ROBERT BALLARD,
COUNTY RECORDER



12/01/2016 10:21 AM Fee: \$15.00

PAGE: 1 of 2

AFFIDAVIT OF PERFORMANCE OF ANNUAL WORK

1. State of Arizona, County of Mohave ss:

2. I (Name) Charles Clark

3. Reside at (Address) 1137 Topeka St

City Kingman County Mohave

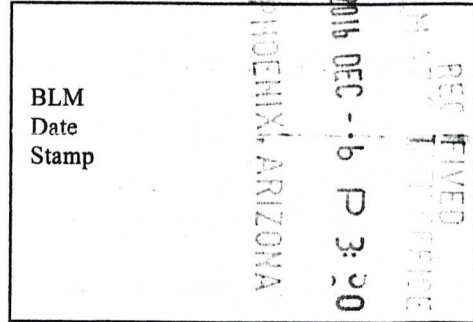

State AZ Zip 86401 being duly sworn, depose and say that I am a citizen of the United States, more than eighteen years of age, and that all of the facts set forth in this affidavit, subject to the provisions and penalties of 18 U.S.C. 1001 pertaining to the filing of false, fictitious, or fraudulent statements with the United States, are true and correct according to the best of my knowledge, information and belief.

4. Owner's name and address (if not shown in Items 1-3 above). _____

5. That I am personally acquainted with the mining claim(s). The work and improvements were made by and at the expense of the owner(s) of said claim(s). Said contiguous group of claims, listed on this document, are situated in the

McConnico (optional) Mining District; Mohave County, Arizona.

Line No.	AMC NUMBER	CLAIM/SITE NAME	COUNTY RECORDER DATA (If available)	TWP	RNG	SEC
1	396376	Boulder Creek	2016054494	20	17	10
2						
3						
4						
5						
6						

Form: MCF108
Revised July 2014
Page 1 of 2

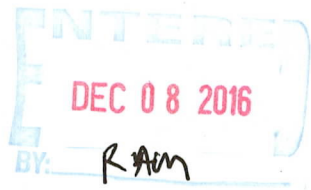

BLM
Date
Stamp

RECEIVED
2016 DEC -6 P 3:50
PHOENIX, ARIZONA

7					
8					
9					
10					

6. That between the dates starting at 12 o'clock noon on September 1, 20 15 and ending at 12 o'clock noon on September 1, 20 16 at least \$ 100 dollars worth of work and improvements were done and performed upon said claim(s) or upon one or more of a contiguous group of claims for the benefit of all, wholly or partly outside of a contiguous group of claims for the benefit of all, not including the location work.

7. That the following persons were employed to perform the work and improvements described herein: self

8. That the work and improvements performed were: Added more timbers in shaft

9. Dated: 12-1-16 Signature: Charles Clark

SUBSCRIBED AND SWORN TO before me, a Notary Public, this 1ST day of DECEMBER 20 16

By: CHARLES W. CLARK

Notary Public Tasha A Johnston

My Commission Expires 12 21 2019

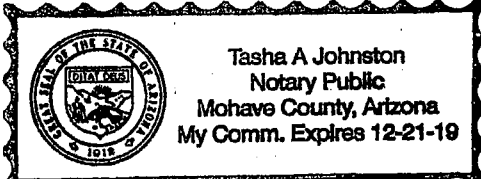

Bureau of Land Management
Arizona State Office
www.blm.gov/az

No. of Claims: 1 x \$10 = \$10.00
Check No.: M.D. Init. AKJ
Receipt No.: 3716978
For BLM Use Only

Charles Clark
1137 Topeka St
Kingman AZ
86401
AMC396376

LAS VEGAS, NV 890
01 DEC 2016 PM 4 1



Bureau of Land Management
Mining Claim Filings
One North Central Ave., Ste 800
Phoenix, AZ 85004-4427

BLM RECEIVED
2016 DEC - 6 P 3:49
PHOENIX, ARIZONA

85004-442700



United States Department of the Interior
Bureau of Land Management
 DIV OF LANDS, MINRLS & ENERGY
 ONE N CENTRAL AVE
 PHOENIX, AZ 85004 -4427
 Phone: 602-417-9200

Receipt

No: 3716978

Transaction #: 3822029	
Date of Transaction: 12/07/2016	
CUSTOMER:	
CHARLES CLARK 1137 TOPEKA ST KINGMAN, AZ 86401-6271 US	

LINE #	QTY	DESCRIPTION	REMARKS	UNIT PRICE	TOTAL
1	1.00	LOCATABLE MINERALS / MINING CLAIMS- NOT NEW-UNADJUD, ONE AUTH NO. ONLY / MINING CLAIM MONEY RECEIVED CASES: AMC396376/\$10.00	POL (1) 2016	- n/a -	10.00
TOTAL:					\$10.00

PAYMENT INFORMATION					
1	AMOUNT:	10.00	POSTMARKED:	12/01/2016	
	TYPE:	CHECK	RECEIVED:	12/06/2016	
	CHECK NO:	50709011062			
	NAME:	CLARK, CHARLES 1137 TOPEKA ST KINGMAN AZ 86401-6271 US			

REMARKS

This receipt was generated by the automated BLM Collections and Billing System and is a paper representation of a portion of the official electronic record contained therein.

UNITED STATES
DEPARTMENT OF THE INTERIOR
BUREAU OF LAND MANAGEMENT

MAINTENANCE FEE WAIVER CERTIFICATION

83

RAM

396376

FORM APPROVED
OMB NO. 1004-0114
Expires: October 31, 2016

SEE INSTRUCTIONS ON PAGE 2

1. This small miner waiver is filed for the assessment year beginning on September 1, ~~2015~~²⁰¹⁶ and ending on September 1, ~~2016~~²⁰¹⁷.
2. The undersigned and all related parties own ten or fewer mining claims, mill, or tunnel sites located and maintained on Federal lands in the United States of America on September 1, ~~2015~~²⁰¹⁶.
3. The undersigned have performed the assessment work required by law for each mining claim listed prior to filing this waiver and understand that by filing this form, the undersigned must file an affidavit of assessment work with the Bureau of Land Management (BLM) by the December 30th following the filing of this waiver.
4. The undersigned understand that if the assessment work obligation has not yet come due under 30 U.S.C. 28 (for those claims in their first assessment year only), a notice of intent to hold reciting this condition must be recorded by the December 30th following the filing of this waiver.
5. The undersigned understand that mill and tunnel sites may also be listed on this waiver and be waived from payment of the maintenance fee, and that a notice of intent to hold for these sites is required to be filed with the BLM by the December 30th following the filing of this waiver.
6. The undersigned understand and acknowledge that pursuant to 43 U.S.C. 1212 and 18 U.S.C. 1001, the filing or recording of a false, fictitious, or fraudulent document with the BLM may result in a fine of up to \$250,000, a prison term not to exceed five years, or both.
7. The mining claims, mill or tunnel sites for which this waiver from payment of the maintenance fees is requested are:

CLAIM OR SITE NAME	BLM RECORDATION SERIAL NUMBER
1. Boulder Creek Lode Mine ✓	AMC396376
2.	
3.	
4.	
5.	
6.	
7.	
8.	
9.	
10.	

RECEIVED
BLM APPOINTMENT OFFICE
2016 JUL -8 P 2:39
PHOENIX, ARIZONA

The owner(s) (claimants) of the above mining claims and sites are:

Charles Clark

(Owner's Name - Please Print)

Charles Clark

(Owner's Signature)

1137 Topeka Street

(Owner's Mailing Address)

Kingman AZ 86401

(City) (State) (Zip Code)

(Owner's Name - Please Print)

(Owner's Signature)

(Owner's Mailing Address)

(City) (State) (Zip Code)

(Owner's Name - Please Print)

(Owner's Signature)

(Owner's Mailing Address)

(City) (State) (Zip Code)

(Owner's Name - Please Print)

(Owner's Signature)

(Owner's Mailing Address)

(City) (State) (Zip Code)

ENTERED
483
AUG 30 2016
BY: *RAM*

*NWJ
an*

(Owner's Name - Please Print)	(Owner's Signature)
(Owner's Mailing Address)	(City) (State) (Zip Code)
(Owner's Name - Please Print)	(Owner's Signature)
(Owner's Mailing Address)	(City) (State) (Zip Code)
(Owner's Name - Please Print)	(Owner's Signature)
(Owner's Mailing Address)	(City) (State) (Zip Code)
(Owner's Name - Please Print)	(Owner's Signature)
(Owner's Mailing Address)	(City) (State) (Zip Code)

18 U.S.C. 1001 and 43 U.S.C. 1212 make it a crime for any person knowingly and willfully to make to any department or agency of the United States any false, fictitious or fraudulent statements or representations as to any matter within its jurisdiction.

INSTRUCTIONS

1. This certification is made under the provisions of 43 U.S.C. § 1744 and 30 U.S.C. §28-28k and the regulations thereunder (43 CFR Part 3830).
2. The claimant(s) must fill in the dates in paragraph 1 for the beginning and ending of the assessment year for which this waiver is sought.
3. The claimant(s) must fill in the date in paragraph 2 for the beginning of the assessment year for which this waiver is sought.
4. All claim and site names and BLM serial numbers must be listed for the mining claims, mill sites, and tunnel sites for which the waiver is sought.
5. All owners of the mining claims, mill sites, and tunnel sites and their addresses must be given.
6. This waiver form must be signed by all the claimants or their designated agent, in original form. If an agent is designated, a notarized designation of agent, signed by all of the claimants with proper address given, must be submitted with this waiver.
7. This form must be filed no later than September 1st for the upcoming assessment year in the BLM State Office where the mining claims or sites are recorded, or the waiver cannot be granted by the BLM. (Example: To obtain a waiver for the assessment year 2012, which begins on September 1, 2011, you must qualify for and file for a waiver no later than September 1, 2011, in the proper BLM State Office.)
8. For all mining claims which require assessment work, you must record an affidavit of labor on or before the December 30th immediately following the filing of this waiver. For all other mining claims or sites waived, you must record a notice of intent to hold on or before the December 30th immediately following the filing of this waiver.
9. Mill and tunnel sites may also be listed on this waiver and be waived from payment of the maintenance fee. A notice of intent to hold for these sites is required to be filed by the December 30th following the filing of this waiver.

FOR OFFICIAL USE ONLY

Charles Clark
1137 Topelka St
Kingman AZ
86401

AMC396376

← UPDATED
ADDRESS

LAS VEGAS NV 890

06 JUL 2016 PM 5 L

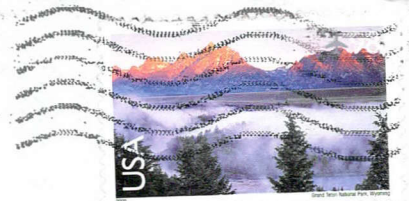

BLM - Mining Claim Filings
One North Central Ave Ste 800
Phoenix, Arizona 85004-4427

85004-442700



UNITED STATES
DEPARTMENT OF THE INTERIOR
BUREAU OF LAND MANAGEMENT

FORM APPROVED
OMB NO.: 1004-0114
Expires: October 31, 2016

396376

AFFIDAVIT OF ANNUAL ASSESSMENT WORK

WHEN RECORDED, MAIL DOCUMENT TO:

NAME: Charles Clark

ADDRESS: 1137 Topeka Street

CITY, STATE, ZIP: Kingman, Arizona 86401



FEE# 2015053023

OFFICIAL RECORDS
OF MOHAVE COUNTY
CAROL MEIER,
COUNTY RECORDER



12/01/2015 01:36 PM Fee: \$15.00

PAGE: 1 of 4

No. of Claims 1
x \$10/claim
Total due BLM \$ 10

TO ALL WHOM IT MAY CONCERN:

- The undersigned certifies that at least \$100 per claim was expended for development, labor and improvements, or equivalent value added, as the annual assessment work for the assessment year ending September 1, 2015 for the following contiguous unpatented mining claim(s), located in the County of Mohave, in the State of Arizona

BLM Serial No.	Name of Claim	Tp Rg Sec Mer				County Recordation Book and Page No.	Date
		Example: 13N 5E 14 MDM					
AMC396376	Boulder Creek Lode	20	17	10	MDM	2015053023	12/01/2015

RECEIVED
 2015 DEC 3 11:00
 FIDELITY AMERICAN

(Continued on page 2)



RECEIPT # 3447017

BY: *Ryan*

2. Type of labor and improvements (specify what was done and give the total value for that labor and improvement to show at least \$100 for each claim). If a geological, geochemical, or geophysical survey was performed, as per 30 U.S.C. 28-1, reference the title of the report of survey; give cost and date of the survey and report, and indicate it was filed with the County Recorder:

Description of Work Performed	Value of Work Performed	Date Work Was Performed
Hand worked access road for flood drainages	\$300	2015

3. Name and mailing address of each person who performed the labor and improvements:

Name (please print)
Charles Clark

Current Mailing Address (please print)
1137 Topeka St., Kingman Arizona 86401

4. Name and mailing address of each person who holds and claims the subject mining claim(s) for the valuable minerals contained therein. Be sure to indicate if there is a change of address:

Name (please print)
Charles Clark

Current Mailing Address (please print)
1137 Topeka St., Kingman Arizona 86401

5. The undersigned testifies that on the date of August 22, 20¹⁵, all monuments required by law were erected upon the subject claim(s), and all notices required by law were posted on the subject claim(s) or copies thereof were in place, and at said date, each corner monument bore or contained

markings sufficient to appropriately designate the corner of the claim to which it pertains and the name of the claim(s).

I hereby certify under penalty of perjury under the laws of the State of Arizona that the foregoing statements are true and correct.

Charles Clark Date: 12-1-2015
(Signature of person responsible for above statement)

Title 18 U.S.C. 1001 and 43 U.S.C. 1212 make it a crime for any person knowingly and willfully to make to any department or agency of the United States any false, fictitious or fraudulent statements or representations as to any matter within its jurisdiction.

Notary Block

~~SUBSCRIBED AND SWORN TO~~ Before me, this 1 day of December 2015

By: [Signature]
(Signature of Affiant)

Title: Notary Public

My Commission Expires: 9/9/2018

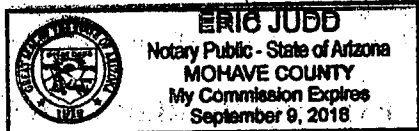

INSTRUCTIONS

1. This is an optional form that may be used to satisfy the requirements for the Bureau of Land Management (BLM) under the provisions of 43 U.S.C. §1744 and 30 U.S.C. §28-28d and the regulations thereunder (43 CFR part 3835). Since local and State laws may vary, you should contact your local and State agencies where the claims are located to ensure all applicable laws and requirements are satisfied.
2. The claimant(s) must fill in the date in paragraph 1 for the applicable assessment year and the county and state where the claims are located.
3. All claim names, BLM serial numbers, legal descriptions, and original county recording information must be listed for the claims pertaining to this assessment notice.
4. The claimant(s) must complete paragraph 2 listing all labor or improvements which was performed on or did benefit the subject mining claims. The value and date of the labor or improvements must also be listed. The total amount of labor or improvements can be listed, but the total expenditure must equal at least \$100 for each claim.
5. The names and current mailing addresses of the person(s) performing the labor shall be listed in paragraph 3.
6. The name and current mailing address of each owner (claimant) of the claims shall be listed in paragraph 4. The mailing address shall be the owner's address and not the address of an agent or anyone representing the claimant. Be sure to note if there has been a change of address.
7. Paragraph 5 shall be completed to show the date it was verified that all monuments required by law were properly erected, all notices were posted, and that corners were appropriately designated for all claims listed.
8. An exact legible reproduction or duplicate (other than microfilm or other electronic media) of this affidavit or another type of affidavit of assessment work that you file or will file in the county where each claim is located, must be filed with the BLM on or before December 30 of the calendar year in which the assessment year ends. For mill or tunnel sites, a separate notice of intent to hold must be filed with the BLM on or before December 30. Requirements for filing a notice of intent to hold can be found at 43 CFR 3835.33.
9. A processing fee of \$10 for each claim listed must be remitted to the BLM along with this or any other affidavit of assessment work.

NOTICES

THE PRIVACY ACT and 43 CFR 2.48(d) require that you be furnished with the following information in connection with the information requested by this form.

AUTHORITY: 30 U.S.C. §28-28d and 43 CFR part 3835; permit collection of the information requested by this form.

PRINCIPAL PURPOSE: The BLM will use the information you provide to document compliance with 43 U.S.C. 1744 and that assessment work has been completed in accordance with 30 U.S.C. § 28-28d and 43 CFR part 3835 in lieu of paying the maintenance fee for the mining claims listed on this form.

ROUTINE USES: The BLM will only disclose this information in accordance with the provisions at 43 CFR 2.56(b) and (c).

EFFECT OF NOT PROVIDING INFORMATION: Disclosure of the requested information is required by 30 U.S.C. § 28-28d and 43 CFR part 3835 for claimants qualified to perform assessment work in lieu of paying the maintenance fee. Failure to submit all the requested information or to complete this form will delay the BLM's processing of the form and may preclude the BLM's acceptance of the assessment work information, which may result in forfeiture of the mining claim(s) by the claimant.

THE PAPERWORK REDUCTION ACT requires us to inform you that:

Use of this form is optional. You must perform assessment if a waiver to pay the maintenance fee has been requested. This form is provided to help you attest that annual assessment work has been completed in lieu of paying the maintenance fee for your claim(s). Submission of the requested information is necessary to obtain or retain a benefit.

You do not have to respond to this or any other Federal agency-sponsored information collection unless it displays a valid OMB control number.

BURDEN HOURS STATEMENT: The estimated public reporting burden for this form is 30 minutes per response, including the time for reviewing instructions, gathering and maintaining data, and completing and reviewing the form. You may submit comments regarding the burden estimate or any other aspect of this form to: U.S. Department of the Interior, Bureau of Land Management (1004-0114), Bureau Information Collection Clearance Officer (WO-630), 1849 C Street, N.W., Room 2134LM, Washington, D.C. 20240.

RECEIVED
DEC 3 3 40
OFFICE

Charles Clark
1137 Topeka St
Kingman AZ
86401

AMC396376

RECEIVED
BLM AZ
2015 DEC -3 P 3:34
PHOENIX, ARIZONA

LAS VEGAS NV 890
01 DEC 2015 PM 3 L

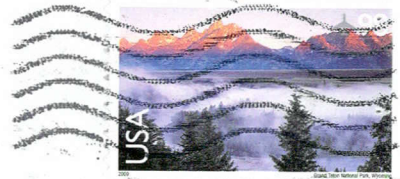

Bureau of Land Management
Mining Claim Filings
One North Central Ave, Ste 800
Phoenix, Arizona 85004

85004442700



United States Department of the Interior
Bureau of Land Management
LANDS/RECREATION & PLANNING
ONE N CENTRAL AVE
PHOENIX, AZ 85004 -2203
Phone: 602-417-9200

Receipt

No: 3447017

Transaction #: 3546429	
Date of Transaction: 12/04/2015	
CUSTOMER:	
CHARLES CLARK 1137 TOPEKA ST KINGMAN, AZ 86401-6271 US	

LINE #	QTY	DESCRIPTION	REMARKS	UNIT PRICE	TOTAL
1	1.00	LOCATABLE MINERALS / MINING CLAIMS- NOT NEW-UNADJUD, ONE AUTH NO. ONLY / MINING CLAIM MONEY RECEIVED CASES: AMC396376/\$10.00	POL - 1 2015	- n/a -	10.00
TOTAL:					\$10.00

PAYMENT INFORMATION					
1	AMOUNT:	10.00	POSTMARKED:	12/01/2015	
	TYPE:	CHECK	RECEIVED:	12/03/2015	
	CHECK NO:	51182110585			
	NAME:	CLARK, CHARLES 1137 TOPEKA ST KINGMAN AZ 86401-6271 US			

REMARKS

This receipt was generated by the automated BLM Collections and Billing System and is a paper representation of a portion of the official electronic record contained therein.

UNITED STATES
DEPARTMENT OF THE INTERIOR
BUREAU OF LAND MANAGEMENT

MAINTENANCE FEE WAIVER CERTIFICATION

SEE INSTRUCTIONS ON PAGE 2

[Handwritten scribbles]
RAM
174

396376

FORM APPROVED
OMB NO. 1004-0114
Expires: October 31, 2016

1. This small miner waiver is filed for the assessment year beginning on September 1, ~~2014~~²⁰¹⁵ and ending on September 1, ~~2015~~²⁰¹⁶.
2. The undersigned and all related parties owned ten or fewer mining claims, mill, or tunnel sites located and maintained on Federal lands in the United States of America on September 1, ~~2015~~²⁰¹⁵.
3. The undersigned have performed the assessment work required by law for each mining claim listed prior to filing this waiver and understand that by filing this form, the undersigned must file an affidavit of assessment work with the Bureau of Land Management (BLM) by the December 30th following the filing of this waiver.
4. The undersigned understand that if the assessment work obligation has not yet come due under 30 U.S.C. 28 (for those claims in their first assessment year only), a notice of intent to hold reciting this condition must be recorded by the December 30th following the filing of this waiver.
5. The undersigned understand that mill and tunnel sites may also be listed on this waiver and be waived from payment of the maintenance fee, and that a notice of intent to hold for these sites is required to be filed with the BLM by the December 30th following the filing of this waiver.
6. The undersigned understand and acknowledge that pursuant to 43 U.S.C. 1212 and 18 U.S.C. 1001, the filing or recording of a false, fictitious, or fraudulent document with the BLM may result in a fine of up to \$250,000, a prison term not to exceed five years, or both.
7. The mining claims, mill or tunnel sites for which this waiver from payment of the maintenance fees is requested are:

CLAIM OR SITE NAME	BLM RECORDATION SERIAL NUMBER
1. <i>Boulder Creek Lode Mine</i> ✓	<i>AMC 396376</i>
2.	
3.	
4.	
5.	
6.	
7.	
8.	
9.	
10.	

RECEIVED
BLM AZ STATE OFFICE
2015 AUG -7 P 3:01
PHOENIX, ARIZONA

The owner(s) (claimants) of the above mining claims and sites are:

Charles Clark
(Owner's Name - Please Print)
POB 4393
(Owner's Mailing Address)

Charles Clark
(Owner's Signature)
Kingman *AZ* *86401*
(City) (State) (Zip Code)

(Owner's Name - Please Print)

(Owner's Signature)

(Owner's Mailing Address)

(City) (State) (Zip Code)

(Owner's Name - Please Print)

(Owner's Signature)

(Owner's Mailing Address)

(City) (State) (Zip Code)

(Owner's Name - Please Print)

(Owner's Signature)

(Owner's Mailing Address)

(City) (State) (Zip Code)

(Continued on page 2)

ENTERED
SEP 03 2015
BY: *[Signature]*

NWV
9/3/2015
[Signature]

(Owner's Name - Please Print)	(Owner's Signature)		
(Owner's Mailing Address)	(City)	(State)	(Zip Code)
(Owner's Name - Please Print)	(Owner's Signature)		
(Owner's Mailing Address)	(City)	(State)	(Zip Code)
(Owner's Name - Please Print)	(Owner's Signature)		
(Owner's Mailing Address)	(City)	(State)	(Zip Code)
(Owner's Name - Please Print)	(Owner's Signature)		
(Owner's Mailing Address)	(City)	(State)	(Zip Code)

RECEIVED
 BLM AZ STATE OFFICE
 PHOENIX ARIZONA
 2015 AUG -7 P 3:01

18 U.S.C. 1001 and 43 U.S.C. 1212 make it a crime for any person knowingly and willfully to make to any department or agency of the United States any false, fictitious or fraudulent statements or representations as to any matter within its jurisdiction.

INSTRUCTIONS

1. This certification is made under the provisions of 43 U.S.C. § 1744 and 30 U.S.C. §28-28k and the regulations thereunder (43 CFR Part 3830).
2. The claimant(s) must fill in the dates in paragraph 1 for the beginning and ending of the assessment year for which this waiver is sought.
3. The claimant(s) must fill in the date in paragraph 2 for the beginning of the assessment year for which this waiver is sought.
4. All claim and site names and BLM serial numbers must be listed for the mining claims, mill sites, and tunnel sites for which the waiver is sought.
5. All owners of the mining claims, mill sites, and tunnel sites and their addresses must be given.
6. This waiver form must be signed by all the claimants or their designated agent, in original form. If an agent is designated, a notarized designation of agent, signed by all of the claimants with proper address given, must be submitted with this waiver.
7. This form must be filed no later than September 1st for the upcoming assessment year in the BLM State Office where the mining claims or sites are recorded, or the waiver cannot be granted by the BLM. (Example: To obtain a waiver for the assessment year 2012, which begins on September 1, 2011, you must qualify for and file for a waiver no later than September 1, 2011, in the proper BLM State Office.)
8. For all mining claims which require assessment work, you must record an affidavit of labor on or before the December 30th immediately following the filing of this waiver. For all other mining claims or sites waived, you must record a notice of intent to hold on or before the December 30th immediately following the filing of this waiver.
9. Mill and tunnel sites may also be listed on this waiver and be waived from payment of the maintenance fee. A notice of intent to hold for these sites is required to be filed by the December 30th following the filing of this waiver.

FOR OFFICIAL USE ONLY

Charles Clark
POB 4393
Kingman AZ
86401
AMC396376

LAS VEGAS NV 890

09 AUG 2015 PM 4 1

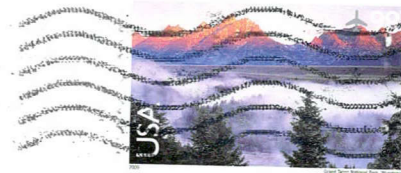

RECEIVED
BLM AZ STATE OFFICE

2015 AUG -7 P 2:49

PHOENIX, ARIZONA

Bureau of Land Management
Mining Claim Division
One North Central Ave, Suite 800
Phoenix Arizona, 85004-4427

85004442700



When Recorded Return Document

Charles Clark
POB 4393
Kingman AZ 86402

← **UPDATED**
12/10/14
Ram

FEE# 2014052282

OFFICIAL RECORDS
OF MOHAVE COUNTY
CAROL MEIER,
COUNTY RECORDER



12/04/2014 01:24 PM Fee: \$15.00

PAGE: 1 of 2

396376

Check here is this is a change of address.

Telephone: 928-279-5939 or 928-273-8988

E-mail address: _____

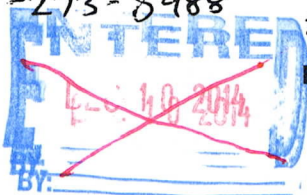

AFFIDAVIT OF PERFORMANCE OF ANNUAL WORK

1. State of Arizona, County of Mohave ss:

2. I (Name) Charles Clark

3. Reside at (Address) 1619 Arlington St

City Kingman County Mohave

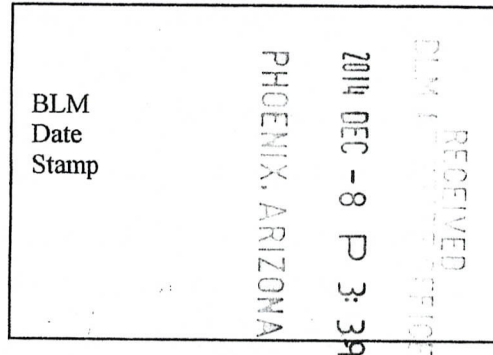

State AZ zip 86401 being duly sworn, depose and say that I am a citizen of the United States, more than eighteen years of age, and that all of the facts set forth in this affidavit, subject to the provisions and penalties of 18 U.S.C. 1001 pertaining to the filing of false, fictitious, or fraudulent statements with the United States, are true and correct according to the best of my knowledge, information and belief.

4. Owner's name and address (If not shown in Items 1-3 above). _____

5. That I am personally acquainted with the mining claim(s). The work and improvements were made by and at the expense of the owner(s) of said claim(s). Said contiguous group of claims, listed on this document, are situated in the

McCannico (optional) Mining District; Mohave County, Arizona.

Line No.	AMC NUMBER	CLAIM/SITE NAME	COUNTY RECORDER DATA (If available)	TWP	RNG	SEC
1	396376	Boulder Creek Mine		20	17	10
2						
3						
4						
5						
6						

Form: MCF108

Revised July 2014

Page 1 of 2

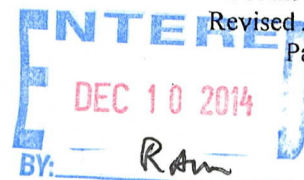

RECEIVED
2014 DEC - 8 P 3: 39
PHOENIX, ARIZONA

BLM
Date
Stamp

7					
8					
9					
10					

6. That between the dates starting at 12 o'clock noon on September 1, 20 13 and ending at 12 o'clock noon on September 1, 20 14 at least \$ 500 dollars worth of work and improvements were done and performed upon said claim(s) or upon one or more of a contiguous group of claims for the benefit of all, wholly or partly outside of a contiguous group of claims for the benefit of all, not including the location work.

7. That the following persons were employed to perform the work and improvements described herein: Self

8. That the work and improvements performed were: improved access road, layed more rail, sunk shaft eight feet deeper

9. Dated: 12-4-2014 Signature: Charles Clark

SUBSCRIBED AND SWORN TO before me, a Notary Public, this 4th day of December 20 14

By: Charles Clark

Notary Public Janis M. Duke

My Commission Expires Sept 3, 2018

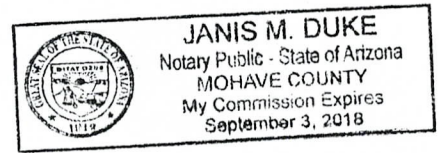

Bureau of Land Management
Arizona State Office
www.blm.gov/az

No. of Claims: 1 x \$10 = \$10.00
 Check No.: M.O. Init. A-H
 Receipt No.: 3186588
 For BLM Use Only

Charles Clark
POB 4393
Kingman AZ
86401

AMC 396376

RECEIVED
OFFICE
2014 DEC -8 P 3:39
PHOENIX, ARIZONA

Bureau of Land Management
Mine Filings Division
One North Central Ave, Ste 800
Phoenix AZ 85004-4427

U.S. MAIL PERMIT NO. 650

04 DEC 2014 PM 2 L

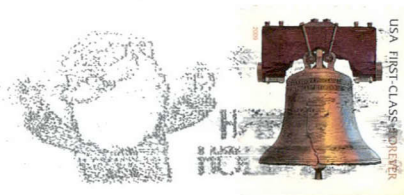

85004442700



United States Department of the Interior
Bureau of Land Management
 LANDS/RECREATION & PLANNING
 ONE N CENTRAL AVE
 PHOENIX, AZ 85004 -2203
 Phone: 602-417-9200

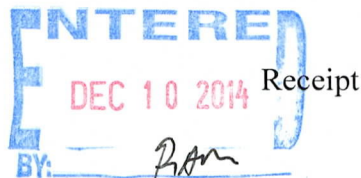

No: 3186588

Transaction #: 3279729	
Date of Transaction: 12/09/2014	
CUSTOMER:	
	CHARLES CLARK PO BOX 4393 KINGMAN, AZ 86402-4393 US

LINE #	QTY	DESCRIPTION	REMARKS	UNIT PRICE	TOTAL
1	1.00	LOCATABLE MINERALS / MINING CLAIMS- NOT NEW-UNADJUD, ONE AUTH NO. ONLY / MINING CLAIM MONEY RECEIVED CASES: AMC396376/\$10.00	POL (1) 2014	- n/a -	10.00
TOTAL:					\$10.00

PAYMENT INFORMATION					
1	AMOUNT:	10.00	POSTMARKED:	12/04/2014	
	TYPE:	CHECK	RECEIVED:	12/08/2014	
	CHECK NO:	51109420983			
	NAME:	CLARK, CHARLES PO BOX 4393 KINGMAN AZ 86402-4393 US			

REMARKS

This receipt was generated by the automated BLM Collections and Billing System and is a paper representation of a portion of the official electronic record contained therein.

UNITED STATES
DEPARTMENT OF THE INTERIOR
BUREAU OF LAND MANAGEMENT
MAINTENANCE FEE WAIVER CERTIFICATION

1127

fm

Amc 396376

FORM APPROVED
OMB NO. 1004-0114
Expires: October 31, 2016

SEE INSTRUCTIONS ON PAGE 2

- This small miner waiver is filed for the assessment year beginning on September 1, 2014 and ending on September 1, 2015
- The undersigned and all related parties owned ten or fewer mining claims, mill, or tunnel sites located and maintained on Federal lands in the United States of America on September 1, 2014.
- The undersigned have performed the assessment work required by law for each mining claim listed prior to filing this waiver and understand that by filing this form, the undersigned must file an affidavit of assessment work with the Bureau of Land Management (BLM) by the December 30th following the filing of this waiver.
- The undersigned understand that if the assessment work obligation has not yet come due under 30 U.S.C. 28 (for those claims in their first assessment year only), a notice of intent to hold reciting this condition must be recorded by the December 30th following the filing of this waiver.
- The undersigned understand that mill and tunnel sites may also be listed on this waiver and be waived from payment of the maintenance fee, and that a notice of intent to hold for these sites is required to be filed with the BLM by the December 30th following the filing of this waiver.
- The undersigned understand and acknowledge that pursuant to 43 U.S.C. 1212 and 18 U.S.C. 1001, the filing or recording of a false, fictitious, or fraudulent document with the BLM may result in a fine of up to \$250,000, a prison term not to exceed five years, or both.
- The mining claims, mill or tunnel sites for which this waiver from payment of the maintenance fees is requested are:

CLAIM OR SITE NAME	BLM RECORDATION SERIAL NUMBER
1. <u>Boulder Creek</u>	<u>AMC396376</u> ✓
2.	
3.	
4.	
5.	
6.	
7.	
8.	
9.	
10.	

The owner(s) (claimants) of the above mining claims and sites are:

Charles Clark

(Owner's Name - Please Print)

Charles Clark

(Owner's Signature)

POB 451 Kingman AZ 86401

(Owner's Mailing Address)

Kingman

(City)

AZ

(State)

86401

(Zip Code)

(Owner's Name - Please Print)

(Owner's Mailing Address)

(Owner's Signature)

(City)

(State)

(Zip Code)

(Owner's Name - Please Print)

(Owner's Mailing Address)

(Owner's Signature)

(City)

(State)

(Zip Code)

(Owner's Name - Please Print)

(Owner's Mailing Address)

(Owner's Signature)

(City)

(State)

(Zip Code)

(Continued on page 2)

RECEIVED
BLM AZ STATE OFFICE
2014 AUG - 14 P 2:22
PHOENIX, ARIZONA

ENTERED
SEP 05 2014
BY: AT

(Owner's Name - Please Print)

(Owner's Signature)

(Owner's Mailing Address)

(City)

(State)

(Zip Code)

(Owner's Name - Please Print)

(Owner's Signature)

(Owner's Mailing Address)

(City)

(State)

(Zip Code)

(Owner's Name - Please Print)

(Owner's Signature)

(Owner's Mailing Address)

(City)

(State)

(Zip Code)

(Owner's Name - Please Print)

(Owner's Signature)

(Owner's Mailing Address)

(City)

(State)

(Zip Code)

18 U.S.C. 1001 and 43 U.S.C. 1212 make it a crime for any person knowingly and willfully to make to any department or agency of the United States any false, fictitious or fraudulent statements or representations as to any matter within its jurisdiction.

INSTRUCTIONS

1. This certification is made under the provisions of 43 U.S.C. § 1744 and 30 U.S.C. §28-28k and the regulations thereunder (43 CFR Part 3830).
2. The claimant(s) must fill in the dates in paragraph 1 for the beginning and ending of the assessment year for which this waiver is sought.
3. The claimant(s) must fill in the date in paragraph 2 for the beginning of the assessment year for which this waiver is sought.
4. All claim and site names and BLM serial numbers must be listed for the mining claims, mill sites, and tunnel sites for which the waiver is sought.
5. All owners of the mining claims, mill sites, and tunnel sites and their addresses must be given.
6. This waiver form must be signed by all the claimants or their designated agent, in original form. If an agent is designated, a notarized designation of agent, signed by all of the claimants with proper address given, must be submitted with this waiver.
7. This form must be filed no later than September 1st for the upcoming assessment year in the BLM State Office where the mining claims or sites are recorded, or the waiver cannot be granted by the BLM. (Example: To obtain a waiver for the assessment year 2012, which begins on September 1, 2011, you must qualify for and file for a waiver no later than September 1, 2011, in the proper BLM State Office.)
8. For all mining claims which require assessment work, you must record an affidavit of labor on or before the December 30th immediately following the filing of this waiver. For all other mining claims or sites waived, you must record a notice of intent to hold on or before the December 30th immediately following the filing of this waiver.
9. Mill and tunnel sites may also be listed on this waiver and be waived from payment of the maintenance fee. A notice of intent to hold for these sites is required to be filed by the December 30th following the filing of this waiver.

RECEIVED
BLM AZ STATE OFFICE
2011 AUG -4 P 2:22
PHOENIX, ARIZONA

FOR OFFICIAL USE ONLY

Charles Clark
POB 457
Kingman AZ
86401

AMC396376

RECEIVED
BLM AZ STATE OFFICE

2014 AUG -4 P 2:22

PHOENIX, ARIZONA

Bureau of Land Management
Mine Claim Filings
7 North Central Ave, Suite 800
Phoenix, Arizona
85004-4421

LAS VEGAS NV 890

01 AUG 2014 PM 4 L



85004442700



396376

When Recorded Return Document to:
Charles Clark
POB 451
Kingman, AZ 86401

FEE# 2013060733

OFFICIAL RECORDS
OF MOHAVE COUNTY
CAROL MEIER,
COUNTY RECORDER



12/03/2013 11:44 AM Fee: \$15.00

PAGE: 1 of 2

Check here is this is a change of address.

Telephone: 928-279-5939 or 928-273-5988

E-mail address: _____

AFFIDAVIT OF PERFORMANCE OF ANNUAL WORK

1. State of Arizona, County of Mohave ss:

2. I (Name) Charles Clark

3. Reside at (Address) 1619 Arlington St

City Kingman County Mohave

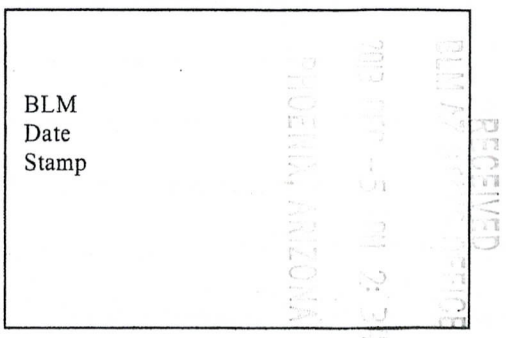

State AZ zip 86401 being duly sworn, depose and say that I am a citizen of the United States, more than eighteen years of age, and that all of the facts set forth in this affidavit, subject to the provisions and penalties of 18 U.S.C. 1001 pertaining to the filing of false, fictitious, or fraudulent statements with the United States, are true and correct according to the best of my knowledge, information and belief.

4. Owner's name and address (If not shown in Items 1-3 above). _____

5. That I am personally acquainted with the mining claim(s). The work and improvements were made by and at the expense of the owner(s) of said claim(s). Said contiguous group of claims, listed on this document, are situated in the

McLennico (optional) Mining District; Mohave County, Arizona.

Line No.	AMC NUMBER	CLAIM/SITE NAME	COUNTY RECORDER DATA (If available)	TWP	RNG	SEC
1	396376	Boulder Creek Lode	2013060733	20N	17W	10
2						
3						
4						
5						
6						

Form: MCF108
Revised Jan. 2006
Page 1 of 2



BLM
Date
Stamp

PHOENIX, ARIZONA
DEC 2 2013
PM 2:34

PROCESSED
BLM / ARIZONA
2013 DEC 2 2:34 PM

7						
8						
9						
10						

6. That between the dates starting at 12 o'clock noon on September 1, 20 12 and ending at 12 o'clock noon on September 1, 20 13 at least \$ 200 dollars worth of work and improvements were done and performed upon said claim(s) or upon one or more of a contiguous group of claims for the benefit of all, wholly or partly outside of a contiguous group of claims for the benefit of all, not including the location work.

7. That the following persons were employed to perform the work and improvements described herein: self

8. That the work and improvements performed were: hand tooled drainages along mine road to control flooding monsoon rain waters.

9. Dated: 12-3-13 Signature: Charles Clark

SUBSCRIBED AND SWORN TO before me, a Notary Public, this 3rd day of December 20 13

By: Charles Clark

Notary Public Deborah K. Blair

My Commission Expires 6-5-15

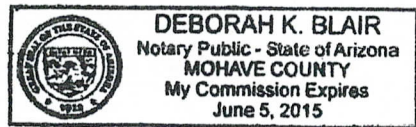

Bureau of Land Management
Arizona State Office

No. of Claims: 1 x \$10 = \$10.00
 Check No.: M.O. Init: AKW
 Receipt No.: 2925489
 For BLM Use Only

Charles Clark
POB 451
Kingman AZ
86402

RECEIVED
BLM AZ FIELD OFFICE

AV 396376

2013 DEC -5 PM 2:34

PHOENIX, ARIZONA

Bureau of Land Management
Mining Claim Filings
One North Central Ave., Ste 800
Phoenix Arizona 85004-4427



Apply Priority Mail Postage Here

UNITED STATES POSTAGE
PITNEY BOWES
02 1P \$ 011.25⁰
0001677650 DEC 03 2013
MAILED FROM ZIP CODE 86401

PLACE STICKER AT TOP OF ENVELOPE TO THE RIGHT OF THE RETURN ADDRESS. FOLD AT DOTTED LINE

CERTIFIED MAIL

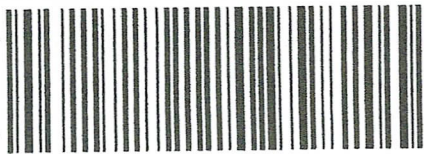

7002 0510 0000 1751 1604

RECEIVED
PITNEY BOWES OFFICE
2013 DEC 03 PM 2:53
PHOENIX, ARIZONA

United States Department of the Interior
Bureau of Land Management
 LANDS/RECREATION & PLANNING
 ONE N CENTRAL AVE
 PHOENIX, AZ 85004 -2203
 Phone: 602-417-9200

Receipt

No: 2925489

Transaction #: 3012729	
Date of Transaction: 12/06/2013	
CUSTOMER:	
CHARLES CLARK PO BOX 451 KINGMAN, AZ 86402-0451 US	

LINE #	QTY	DESCRIPTION	REMARKS	UNIT PRICE	TOTAL
1	1.00	LOCATABLE MINERALS / MINING CLAIMS- NOT NEW-UNADJUD, ONE AUTH NO. ONLY / MINING CLAIM MONEY RECEIVED CASES: AMC396376/\$10.00	POL (1) 2013	- n/a -	10.00
TOTAL:					\$10.00

PAYMENT INFORMATION					
1	AMOUNT:	10.00	POSTMARKED:	12/03/2013	
	TYPE:	CHECK	RECEIVED:	12/05/2013	
	CHECK NO:	50993427161			
	NAME:	CLARK, CHARLES PO BOX 451 KINGMAN AZ 86402-0451 US			

REMARKS

This receipt was generated by the automated BLM Collections and Billing System and is a paper representation of a portion of the official electronic record contained therein.

Charles Clark
POB 451
Kingman AZ
86401

RECEIVED
BLM AZ STATE OFFICE

AMC 396376

2013 AUG -2 PM 3:11
PHOENIX, ARIZONA

Bureau of Land Management
Mining Claims Division
One North Central Ave., Ste 800
Phoenix Arizona 85004-4427



8500484427



Charles Clark
POB 451
Kingman AZ
86401

RECEIVED
BLM AZ STATE OFFICE

AMC396376 2013 AUG -2 PM 3:11
PHOENIX, ARIZONA

Bureau of Land Management
Mining Claims Division
One North Central Ave., Ste 800
Phoenix Arizona 85004-4427

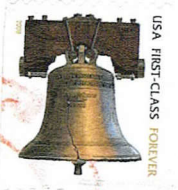

8500484427



Charles Clark
POB 451
Kingman AZ
86401

RECEIVED
BLM AZ STATE OFFICE

AMC 396376 2013 AUG -2 PM 3:11
PHOENIX, ARIZONA

Bureau of Land Management
Mining Claims Division
One North Central Ave., Ste 800
Phoenix Arizona 85004-4427

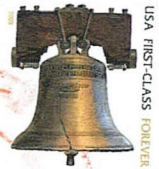

8500484427



When Recorded Return Document to:

Charles Clark
POB 451
Kingman AZ 86402

2

Check here is this is a change of address.

Telephone: 928-273-5988 or 928-279-5939

E-mail address: _____



FEE# 2012057140

OFFICIAL RECORDS
OF MOHAVE COUNTY
CAROL MEIER,
COUNTY RECORDER



11/01/2012 12:11 PM Fee: \$15.00

PAGE: 1 of 2

Amc 396376

AFFIDAVIT OF PERFORMANCE OF ANNUAL WORK

1. State of Arizona, County of Mohave ss:

2. I (Name) Charles Clark

3. Reside at (Address) 909 Andy Devine Ave

City Kingman County Mohave

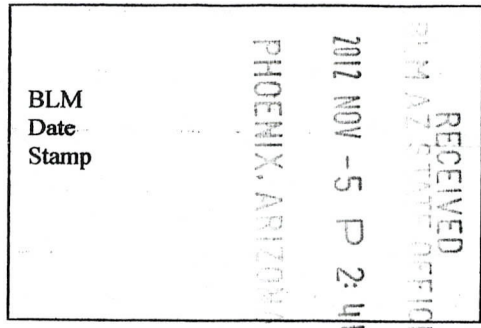

State AZ Zip 86402 being duly sworn, depose and say that I am a citizen of the United States, more than eighteen years of age, and that all of the facts set forth in this affidavit, subject to the provisions and penalties of 18 U.S.C. 1001 pertaining to the filing of false, fictitious, or fraudulent statements with the United States, are true and correct according to the best of my knowledge, information and belief.

4. Owner's name and address (If not shown in Items 1-3 above). _____

5. That I am personally acquainted with the mining claim(s). The work and improvements were made by and at the expense of the owner(s) of said claim(s). Said contiguous group of claims, listed on this document, are situated in the

McConnico (optional) Mining District; Mohave County, Arizona.

Line No.	AMC NUMBER	CLAIM/SITE NAME	COUNTY RECORDER DATA (If available)	TWP	RNG	SEC
1	396376	Boulder Creek Lode Mine		20N	17W	10
2						
3						
4						
5						
6						

ENTERED INTO COMPUTER

NOV 16 2012 PB

Form: MCF108
Revised Jan. 2006
Page 1 of 2

RECEIVED
BLM AZ STATE OFFICE

BLM
Date: 2012 NOV -5 P 2:46
Stamp

PHOENIX, ARIZONA

7						
8						
9						
10						

6. That between the dates starting at 12 o'clock noon on September 1, 20 11 and ending at 12 o'clock noon on September 1, 20 12 at least \$ 200 dollars worth of work and improvements were done and performed upon said claim(s) or upon one or more of a contiguous group of claims for the benefit of all, wholly or partly outside of a contiguous group of claims for the benefit of all, not including the location work.

7. That the following persons were employed to perform the work and improvements described herein: self

8. That the work and improvements performed were: laid more track and dug drainage ditches beside access road.

9. Dated: 11/01/2012 Signature: Charles Clark

SUBSCRIBED AND SWORN TO before me, a Notary Public, this 1 day of NOV. 20 12

By: Charles Clark

Notary Public Chanel Turner

My Commission Expires Sept 7, 2016

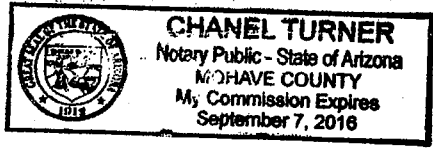

Bureau of Land Management
Arizona State Office
www.az.blm.gov

No. of Claims: 1 x \$10 = \$10.00
 Check No.: M.O. Init. ACT
 Receipt No.: 2685309
 For BLM Use Only

Charles Clark
POB 451
Kingman AZ
86401
AMC396376

Bureau of Land Management
Mine Claim Filings
AZ State Office
One North Central Ave, Suite 800
Phoenix Arizona 85004-4427

RECEIVED
BLM AZ STATE OFFICE
2012 NOV -5 P 2:46
PHOENIX, ARIZONA

Charles Clark
POB 451
Kingman AZ
86401
AMC396376

Bureau of Land Management
Mine Claim Filings
AZ State Office
One North Central Ave, Suite 800
Phoenix Arizona 85004-4427

PHOENIX, ARIZONA

2012 NOV -5 P 2:46

RECEIVED
BLM AZ STATE OFFICE



**PRIORITY
MAIL**

UNITED STATES POSTAL SERVICE®

Apply Priority Mail Postage Here

UNITED STATES POSTAGE

PITNEY BOWES
02 1P \$ 010.45⁰
0001677650 NOV 01 2012
MAILED FROM ZIP CODE 86401

PLACE STICKER AT TOP OF ENVELOPE TO THE RIGHT
OF THE RETURN ADDRESS. FOLD AT DOTTED LINE

CERTIFIED MAIL



7002 0510 0000 1751 1574

United States Department of the Interior
Bureau of Land Management
 LANDS/RECREATION & PLANNING
 ONE N CENTRAL AVE
 PHOENIX, AZ 85004 -2203
 Phone: 602-417-9200

Receipt

No: 2685309

Transaction #: 2766835		ENTERED INTO COMPUTER NOV 16 2012 <i>FB</i>
Date of Transaction: 11/06/2012		
CUSTOMER:		
CHARLES CLARK PO BOX 451 KINGMAN, AZ 86402-0451 US		

LINE #	QTY	DESCRIPTION	REMARKS	UNIT PRICE	TOTAL
1	1.00	LOCATABLE MINERALS / MINING CLAIMS-NOT NEW-UNADJUD, ONE AUTH NO. ONLY / MINING CLAIM MONEY RECEIVED CASES: AMC396376/\$10.00	POL (1) 2012	- n/a -	10.00
TOTAL:					\$10.00

PAYMENT INFORMATION						
1	AMOUNT:	10.00	POSTMARKED:	11/01/2012		
	TYPE:	CHECK	RECEIVED:	11/06/2012		
	CHECK NO:	50866159948				
	NAME:	CLARK, CHARLES PO BOX 451 KINGMAN AZ 86402-0451 US				

REMARKS

This receipt was generated by the automated BLM Collections and Billing System and is a paper representation of a portion of the official electronic record contained therein.

UNITED STATES
DEPARTMENT OF THE INTERIOR
BUREAU OF LAND MANAGEMENT

MAINTENANCE FEE WAIVER CERTIFICATION

P.B.

FORM APPROVED
OMB NO. 1004-0114
Expires: August 31, 2013

145

Amc 396376

SEE INSTRUCTIONS ON PAGE 2

1. This small miner waiver is filed for the assessment year beginning on September 1, ~~2012~~ and ending on September 1, ~~2012~~.
2. The undersigned and all related parties owned ten or fewer mining claims, mill, or tunnel sites located and maintained on Federal lands in the United States of America on September 1, ~~2012~~.
3. The undersigned have performed the assessment work required by law for each mining claim listed prior to filing this waiver and understand that by filing this form, the undersigned must file an affidavit of assessment work with the Bureau of Land Management (BLM) by the December 30th following the filing of this waiver.
4. The undersigned understand that if the assessment work obligation has not yet come due under 30 U.S.C. 28 (for those claims in their first assessment year only), a notice of intent to hold reciting this condition must be recorded by the December 30th following the filing of this waiver.
5. The undersigned understand that mill and tunnel sites may also be listed on this waiver and be waived from payment of the maintenance fee, and that a notice of intent to hold for these sites is required to be filed with the BLM by the December 30th following the filing of this waiver.
6. The undersigned understand and acknowledge that pursuant to 43 U.S.C. 1212 and 18 U.S.C. 1001, the filing or recording of a false, fictitious, or fraudulent document with the BLM may result in a fine of up to \$250,000, a prison term not to exceed five years, or both.
7. The mining claims, mill or tunnel sites for which this waiver from payment of the maintenance fees is requested are:

CLAIM OR SITE NAME	BLM RECORDATION SERIAL NUMBER
1. BOULDER CREEK LODGE MINE	✓ AMC396376
2.	
3.	
4.	
5.	
6.	
7.	
8.	
9.	
10.	

RECEIVED
BLM AZ STATE OFFICE
2012 AUG -6 P 2:52
PHOENIX, ARIZONA

The owner(s) (claimants) of the above mining claims and sites are:

CHARLES CLARK ✓
(Owner's Name - Please Print)

Charles Clark
(Owner's Signature)

POB 451, KINGMAN, ARIZONA 86402.
(Owner's Mailing Address)

(City) (State) (Zip Code)

(Owner's Name - Please Print)

(Owner's Signature)

(Owner's Mailing Address)

(City) (State) (Zip Code)

(Owner's Name - Please Print)

(Owner's Signature)

(Owner's Mailing Address)

(City) (State) (Zip Code)

(Owner's Name - Please Print)

(Owner's Signature)

(Owner's Mailing Address)

(City) (State) (Zip Code)

(Continued on page 2)

ENTERED INTO COMPUTER
8/28/12 AT

RECEIVED
BLM AZ STATE OFFICE
2012 AUG -6 P 5:25
PHOENIX, ARIZONA

(Owner's Name - Please Print)	(Owner's Signature)
(Owner's Mailing Address)	(City) (State) (Zip Code)
(Owner's Name - Please Print)	(Owner's Signature)
(Owner's Mailing Address)	(City) (State) (Zip Code)
(Owner's Name - Please Print)	(Owner's Signature)
(Owner's Mailing Address)	(City) (State) (Zip Code)
(Owner's Name - Please Print)	(Owner's Signature)
(Owner's Mailing Address)	(City) (State) (Zip Code)

18 U.S.C. 1001 and 43 U.S.C. 1212 make it a crime for any person knowingly and willfully to make to any department or agency of the United States any false, fictitious or fraudulent statements or representations as to any matter within its jurisdiction.

INSTRUCTIONS

1. This certification is made under the provisions of 43 U.S.C. § 1744 and 30 U.S.C. §28-28k and the regulations thereunder (43 CFR Part 3830).
2. The claimant(s) must fill in the dates in paragraph 1 for the beginning and ending of the assessment year for which this waiver is sought.
3. The claimant(s) must fill in the date in paragraph 2 for the beginning of the assessment year for which this waiver is sought.
4. All claim and site names and BLM serial numbers must be listed for the mining claims, mill sites, and tunnel sites for which the waiver is sought.
5. All owners of the mining claims, mill sites, and tunnel sites and their addresses must be given.
6. This waiver form must be signed by all the claimants or their designated agent, in original form. If an agent is designated, a notarized designation of agent, signed by all of the claimants with proper address given, must be submitted with this waiver.
7. This form must be filed no later than September 1st for the upcoming assessment year in the BLM State Office where the mining claims or sites are recorded, or the waiver cannot be granted by the BLM. (Example: To obtain a waiver for the assessment year 2012, which begins on September 1, 2011, you must qualify for and file for a waiver no later than September 1, 2011, in the proper BLM State Office.)
8. For all mining claims which require assessment work, you must record an affidavit of labor on or before the December 30th immediately following the filing of this waiver. For all other mining claims or sites waived, you must record a notice of intent to hold on or before the December 30th immediately following the filing of this waiver.
9. Mill and tunnel sites may also be listed on this waiver and be waived from payment of the maintenance fee. A notice of intent to hold for these sites is required to be filed by the December 30th following the filing of this waiver.

FOR OFFICIAL USE ONLY

RECEIVED
BLM AZ STATE OFFICE
2012 AUG -6 P 2:52
PHOENIX, ARIZONA

AMC 396376

When Recorded Return Document to:

2

Charles Clark
POB: 451
Kingman AZ 86402



FEE# 2011060589

OFFICIAL RECORDS
OF MOHAVE COUNTY
CAROL MEIER,
COUNTY RECORDER



Check here is this is a change of address.

Telephone: 928-273-5988

E-mail address: hyderabad2@npgcable.com

12/01/2011 11:54 AM Fee: \$19.00

PAGE: 1 of 2

AFFIDAVIT OF PERFORMANCE OF ANNUAL WORK

1. State of Arizona, County of Mohave ss:
2. I (Name) Charles Clark
3. Reside at (Address) 909 W Andy Devine Ave
POB 451
City Kingman County Mohave

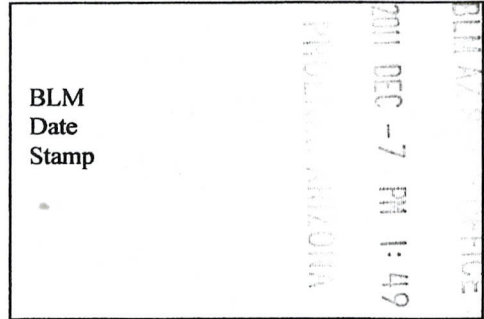

State AZ zip 8640 being duly sworn, depose and say that I am a citizen of the United States, more than eighteen years of age, and that all of the facts set forth in this affidavit, subject to the provisions and penalties of 18 U.S.C. 1001 pertaining to the filing of false, fictitious, or fraudulent statements with the United States, are true and correct according to the best of my knowledge, information and belief.

4. Owner's name and address (If not shown in Items 1-3 above).

5. That I am personally acquainted with the mining claim(s). The work and improvements were made by and at the expense of the owner(s) of said claim(s). Said contiguous group of claims, listed on this document, are situated in the

McCannico (optional) Mining District; Mohave County, Arizona.

Line No.	AMC NUMBER	CLAIM/SITE NAME	COUNTY RECORDER DATA (If available)	TWP	RNG	SEC
1	396376	Boulder Creek Lode Mine		20	17	10
2						
3						
4						
5						
6						

Form: MCF108
Revised Jan. 2006
Page 1 of 2

ENTERED INTO COMPUTER

12/13/11 AT

BLM
Date
Stamp

PHOENIX, ARIZONA
2011 DEC 7 PM 1:49

RECEIVED
BLM ARIZONA OFFICE

7						
8						
9						
10						

6. That between the dates starting at 12 o'clock noon on September 1, 20 10 and ending at 12 o'clock noon on September 1, 20 11 at least \$ 500 dollars worth of work and improvements were done and performed upon said claim(s) or upon one or more of a contiguous group of claims for the benefit of all, wholly or partly outside of a contiguous group of claims for the benefit of all, not including the location work.

7. That the following persons were employed to perform the work and improvements described herein: Self

8. That the work and improvements performed were: installed wooden timbers and started laying track. Also improved more of the mine road. Deepened shaft more.

9. Dated: 12-1-2011 Signature: Charles Clark

SUBSCRIBED AND SWORN TO before me, a Notary Public, this 1st day of December 20 11

By: Charles James Clark

Notary Public Brittany White

My Commission Expires 08/21/2015

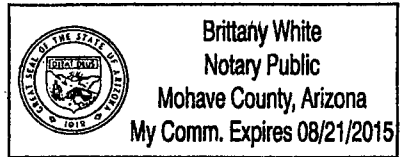

Bureau of Land Management
Arizona State Office
www.az.blm.gov

No. of Claims: 1 x \$10 = 10.00
 Check No.: _____ Init. SM
 Receipt No.: 2478016
 For BLM Use Only

FOR PICKUP CALL 1-800-222-1811

FLAT RATE
2 LB. POST



PRIORITY
MAIL

UNITED STATES POSTAL SERVICE™



PLACE STICKER AT TOP OF ENVELOPE TO THE RIGHT
OF THE RETURN ADDRESS. FOLD AT DOTTED LINE

CERTIFIED MAIL



7002 0510 0000 1751 1598



3. ATTACH LABEL (IF PROVIDED)
Remove label backing and adhere
over customer address block area
(white area).

The efficient FLAT RATE ENVELOPE.
You don't have to weigh the envelope... Just pack
all your correspondence and documents inside
and pay only the small envelope rate.

We Deliver.

Charles Clark
POB 451
Kingman AZ
86401
AMC396376

BLM - Mine Claims
1 N. Central Ave, Suite 800
Phoenix AZ 85004-4427

RECEIVED
BLM
AZ STATE OFFICE
PHOENIX, ARIZONA
DEC - 7 PM 1:49

You don't have to weigh the envelope... Just pack all your correspondence and documents inside and pay only the small envelope rate.

United States Department of the Interior
 Bureau of Land Management
 LANDS/RECREATION & PLANNING
 ONE N CENTRAL AVE
 PHOENIX, AZ 85004 -2203
 Phone: 602-417-9200

Receipt

No:

2478016

Transaction #: 2554498		ENTERED INTO COMPUTER
Date of Transaction: 12/08/2011		
CUSTOMER:		
CHARLES CLARK PO BOX 451 KINGMAN, AZ 86402-0451 US		

LINE #	QTY	DESCRIPTION	REMARKS	UNIT PRICE	TOTAL
1	1.00	LOCATABLE MINERALS / MINING CLAIMS-NOT NEW-UNADJUD, ONE AUTH NO. ONLY / MINING CLAIM MONEY RECEIVED CASES: AMC396376/\$10.00	POL-1	- n/a -	10.00
TOTAL:					\$10.00

PAYMENT INFORMATION					
1	AMOUNT:	10.00	POSTMARKED:	12/01/2011	
	TYPE:	CHECK	RECEIVED:	12/08/2011	
	CHECK NO:	50837513861			
	NAME:	CLARK, CHARLES PO BOX 451 KINGMAN AZ 86402-0451 US			

REMARKS

This receipt was generated by the automated BLM Collections and Billing System and is a paper representation of a portion of the official electronic record contained therein.

UNITED STATES
DEPARTMENT OF THE INTERIOR
BUREAU OF LAND MANAGEMENT

160

FORM APPROVED
OMB NO. 1004-0114
Expires: August 31, 2013

MAINTENANCE FEE WAIVER CERTIFICATION

SEE INSTRUCTIONS ON PAGE 2

Amc 396376

- This small miner waiver is filed for the assessment year beginning on September 1, 2010 and ending on September 1, 2011.
- The undersigned and all related parties owned ten or fewer mining claims, mill, or tunnel sites located and maintained on Federal lands in the United States of America on September 1, 2110.
- The undersigned have performed the assessment work required by law for each mining claim listed prior to filing this waiver and understand that by filing this form, an affidavit of assessment work must be recorded by the December 30th following the filing of this waiver.
- The undersigned understand that if the assessment work obligation has not yet come due under 30 U.S.C. 28 (for those claims in their first assessment year only), a notice of intent to hold reciting this condition must be recorded by the December 30th following the filing of this waiver.
- The undersigned understand that mill and tunnel sites may also be listed upon this waiver and be waived from payment of the maintenance fee, and that a notice of intent to hold for these sites is required to be recorded by the December 30th immediately following the filing of this waiver.
- The undersigned understand and acknowledge that pursuant to 43 U.S.C. 1212 and 18 U.S.C. 1001, the filing or recording of a false, fictitious, or fraudulent document with the Bureau of Land Management may result in a fine of up to \$250,000, a prison term not to exceed five years, or both.
- The mining claims, mill or tunnel sites for which this waiver from payment of the maintenance fees is requested are:

CLAIM OR SITE NAME	BLM RECORDATION SERIAL NUMBER
1. Boulder Creek Lode Mine	AMC396376
2.	
3.	
4.	
5.	
6.	
7.	
8.	
9.	
10.	

The owner(s) (claimants) of the above mining claims and sites are:

Charles Clark ✓
 (Owner's Name - Please Print)
 POB 451
 (Street or P.O. Box)
 Kingman AZ 86402
 (City) (State) (Zip Code)

Charles Clark
 (Owner's Signature)

 (Owner's Name - Please Print)

 (Street or P.O. Box)

 (City) (State) (Zip Code)

 (Owner's Signature)

 (Owner's Name - Please Print)

 (Street or P.O. Box)

 (City) (State) (Zip Code)

 (Owner's Signature)

RECEIVED
 BLM AZ STATE OFFICE
 PHOENIX, ARIZONA
 2011 AUG - 4 P 2:11

ENTERED INTO COMPUTER

(Owner's Name - Please Print)	(Owner's Signature)		
(Street or P.O. Box)	(City)	(State)	(Zip Code)
(Owner's Name - Please Print)	(Owner's Signature)		
(Street or P.O. Box)	(City)	(State)	(Zip Code)
(Owner's Name - Please Print)	(Owner's Signature)		
(Street or P.O. Box)	(City)	(State)	(Zip Code)
(Owner's Name - Please Print)	(Owner's Signature)		
(Street or P.O. Box)	(City)	(State)	(Zip Code)

Title 18 U.S.C. Section 1001 and Title 43 U.S.C. Section 1212 makes it a crime for any person knowingly and willfully to make to any department or agency of the United States any false, fictitious or fraudulent statements or representations as to any matter within its jurisdiction.

INSTRUCTIONS

1. This certification is made under the provisions of §1744 of Title 43 and § 28-28k of Title 30 of the United States Code; and the regulations thereunder (43 CFR Part 3830).
2. The claimant(s) must fill in the dates in paragraph 1 for the beginning and ending of the assessment year for which this waiver is sought.
3. The claimant(s) must fill in the date in paragraph 2 for the beginning of the assessment year for which this waiver is sought.
4. All claim and site names and Bureau of Land Management (BLM) serial numbers must be listed for the mining claims, mill sites, and tunnel sites for which the waiver is sought.
5. All owners of the mining claims, mill sites, and tunnel sites and their addresses must be given.
6. This waiver form must be signed by all the claimants or their designated agent, in original form. If an agent is designated, a notarized designation of agent, signed by all of the claimants with proper address given, must be submitted with this waiver.
7. This form must be filed no later than September 1st for the upcoming assessment year in the BLM State Office where the mining claims or sites are recorded, or the waiver cannot be granted by the BLM. (Example: To obtain a waiver for the assessment year 2012, which begins on September 1, 2011, you must qualify for and file for a waiver no later than September 1, 2011, in the proper BLM State Office.)
8. For all mining claims which require assessment work, you must record an affidavit of labor on or before the December 30th immediately following the filing of this waiver. For all other mining claims or sites waived, you must record a notice of intent to hold on or before the December 30th immediately following the filing of this waiver.
9. Mill and tunnel sites may also be listed upon this waiver and be waived from payment of the maintenance fee. A notice of intent to hold for these sites is required to be filed by the December 30th following the filing of this waiver.

FOR OFFICIAL USE ONLY

Charles Clark
POB 451
Kingman AZ
86401

RECEIVED
U.S. STATE OFFICE

AUG -4 P 2:11

PHOENIX, ARIZONA

LAS VEGAS NV 890

AUG 02 11 PM 5 L



USA FIRST-CLASS FOREVER

BLM - Mine Claims
7 N Central Ave, Ste 800
Phoenix AZ 85004-4427

85004-4427



Charles Clark
POB 451
Kingman AZ
86401

RECEIVED
2011 AUG -4 P 2:11

PHOENIX, ARIZONA

LAS VEGAS NV 890

02 AUG 2011 PM 5 L

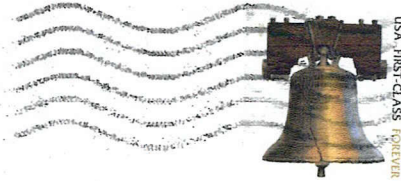

BLM - Mine Claims
1 N Central Ave, Ste 800
Phoenix AZ 85004-4427

85004-4427



2

Amc 396376

When Recorded Return Document to:

Charles Clark ✓
POB 451
Kingman AZ 86402



FEE# 2010070619

OFFICIAL RECORDS
OF MOHAVE COUNTY
CAROL MEIER
COUNTY RECORDER



Address shown as listed in LR-2000 for
Check here is this is a change of address.

Telephone: 928-692-5570

E-mail address: _____

12/03/2010 01:35 PM Fee: \$19.00

PAGE: 1 of 2

AFFIDAVIT OF PERFORMANCE OF ANNUAL WORK

1. State of Arizona, County of Mohave ss:
2. I (Name) Charles Clark
3. Reside at (Address) 909 W Andy Devine Ave
POB 451 ✓
City Kingman County Mohave

RECEIVED
BLM AZ STATE OFFICE
2010 DEC - 8 A 9:26
PHOENIX, ARIZONA
BLM
Date
Stamp

State AZ zip 86402 being duly sworn, depose and say that I am a citizen of the United States, more than eighteen years of age, and that all of the facts set forth in this affidavit, subject to the provisions and penalties of 18 U.S.C. 1001 pertaining to the filing of false, fictitious, or fraudulent statements with the United States, are true and correct according to the best of my knowledge, information and belief.

4. Owner's name and address (If not shown in Items 1-3 above). _____

5. That I am personally acquainted with the mining claim(s). The work and improvements were made by and at the expense of the owner(s) of said claim(s). Said contiguous group of claims, listed on this document, are situated in the

McCannico (optional) Mining District; Mohave County, Arizona.

Line No.	AMC NUMBER	CLAIM/SITE NAME	COUNTY RECORDER DATA (If available)	TWP	RNG	SEC
1	396376	Boulder Creek Lade Mine		20N	17W	10
2						
3						
4						
5						
6						

ENTERED INTO COMPUTER

DEC 20 2010 PB

Form: MCF108
Revised Jan. 2006
Page 1 of 2

RECEIVED
BLM AZ STATE OFFICE
PHOENIX, ARIZONA
2010 DEC - 8 A 9:26
BLM
Date
Stamp

7					
8					
9					
10					

6. That between the dates starting at 12 o'clock noon on September 1, 20 09 and ending at 12 o'clock noon on September 1, 20 10 at least \$ 1000 dollars worth of work and improvements were done and performed upon said claim(s) or upon one or more of a contiguous group of claims for the benefit of all, wholly or partly outside of a contiguous group of claims for the benefit of all, not including the location work.

7. That the following persons were employed to perform the work and improvements described herein: self

8. That the work and improvements performed were: Installed new wooden shaft coverings over shaft with trap doors. Improved/added new shaft support timbers. Installed door at mine portal with lock. Improved access road to mine (hand tooled). Installed new water and air system for mine and deepened shaft (hand tooled).

9. Dated: 12/3/12/2010 Signature: Charles Clark

SUBSCRIBED AND SWORN TO before me, a Notary Public, this 3rd day of December 20 10

By: Charles Clark

Notary Public Marie A. Huxtable

My Commission Expires Aug 4, 2011



Bureau of Land Management
Arizona State Office
www.az.blm.gov

No. of Claims: 1 x \$10 = 10
 Check No.: 6172 Init. FME
 Receipt No.: 2259252
 For BLM Use Only

United States Department of the Interior
Bureau of Land Management
 LANDS/RECREATION & PLANNING
 ONE N CENTRAL AVE
 PHOENIX, AZ 85004 -2203
 Phone:

Receipt

No:

2259252

Transaction #: 2330601		ENTERED INTO COMPUTER
Date of Transaction: 12/08/2010		
CUSTOMER:		DEC 20 2010 <i>FB</i>
CHARLES CLARK PO BOX 451 KINGMAN, AZ 86402-0451 US		

LINE #	QTY	DESCRIPTION	REMARKS	UNIT PRICE	TOTAL
1	1.00	LOCATABLE MINERALS / MINING CLAIMS-NOT NEW-UNADJUD, ONE AUTH NO. ONLY / MINING CLAIM MONEY RECEIVED CASES: AMC396376/\$10.00	POL 2010/1	- n/a -	10.00
TOTAL:					\$10.00

PAYMENT INFORMATION				
1	AMOUNT:	10.00	POSTMARKED:	12/03/2010
	TYPE:	CHECK	RECEIVED:	12/08/2010
	CHECK NO:	50513196172		
	NAME:	CLARK, CHARLES PO BOX 451 KINGMAN AZ 86402-0451 US		

REMARKS

This receipt was generated by the automated BLM Collections and Billing System and is a paper representation of a portion of the official electronic record contained therein.

UNITED STATES DEPARTMENT OF THE INTERIOR
BUREAU OF LAND MANAGEMENT

Amc 396376

148

FORM APPROVED
OMB NO. 1004-0114
Expires: February 28, 2010

MAINTENANCE FEE WAIVER CERTIFICATION

SEE INSTRUCTIONS ON REVERSE

1. This small miner waiver is filed for the assessment year beginning at noon on September 1, 2010 and ending at noon on September 1, 2011.
2. The undersigned and all related parties owned ten or fewer mining claims, mill, or tunnel sites located and maintained on Federal lands in the United States of America on September 1, 2009-2010
3. The undersigned have performed the assessment work **required by law** for each mining claim listed **prior to filing this waiver** and understand that by filing this form; an affidavit of assessment work **must** be recorded by the December 30th following the filing of this waiver.
4. The undersigned understand that if the assessment work obligation has not yet come due under 30 U.S.C. 28 (for those claims in their first assessment year only); a notice of intent to hold reciting this condition **must** be recorded by the December 30th following the filing of this waiver.
5. The undersigned understand that mill and tunnel sites may also be listed upon this waiver and be waived from payment of the maintenance fee; and that a notice of intent to hold for these sites is required to be recorded by the December 30th immediately following the filing of this waiver.
6. The undersigned understand and acknowledge that pursuant to 43 U.S.C. 1212 and 18 U.S.C. 1001; the filing or recording of a false, fictitious, or fraudulent document with the Bureau of Land Management may result in a fine of up to \$250,000, a prison term not to exceed five years, or both.
7. The mining claims, mill or tunnel sites for which this waiver from payment of the maintenance fees is requested are:

CLAIM OR SITE NAME	BLM RECORDATION SERIAL NUMBER
1. Boulder Creek Lode Mine ✓	AMC396376
2.	
3.	
4.	
5.	
6.	
7.	
8.	
9.	
10.	

The owner(s) (claimants) of the above mining claims and sites are:

Charles Clark (Owner's Name - Please Print) Charles Clark (Owner's Signature)

POB 451 (Street or P.O. Box) 8/27/10 Address Updated. ps

Kingman (City) AZ (State) 86402 (Zip Code)

(Owner's Name - Please Print) _____
(Owner's Signature)

(Street or P.O. Box)

(City) _____
(State) _____
(Zip Code)

(Owner's Name - Please Print) _____
(Owner's Signature)

(Street or P.O. Box)

(City) _____
(State) _____
(Zip Code)

(Continued on page 2)

ENTERED INTO COMPUTER

9/8/10 AT

1/PB

RECEIVED
BLM AZ STATE OFFICE
PHOENIX, ARIZONA
2010 AUG -2 P 12:28

(Owner's Name - Please Print)	(Owner's Signature)		
(Street or P.O. Box)	(City)	(State)	(Zip Code)
(Owner's Name - Please Print)	(Owner's Signature)		
(Street or P.O. Box)	(City)	(State)	(Zip Code)
(Owner's Name - Please Print)	(Owner's Signature)		
(Street or P.O. Box)	(City)	(State)	(Zip Code)
(Owner's Name - Please Print)	(Owner's Signature)		
(Street or P.O. Box)	(City)	(State)	(Zip Code)

INSTRUCTIONS

- | | |
|--|--|
| <ol style="list-style-type: none"> 1. This certification is made under the provisions of § 1744 of Title 43 and § 28-28k of Title 30 of the United States Code; and the regulations thereunder (43 CFR Part 3830). 2. The claimant(s) must fill in the dates in paragraph 1 for the beginning and ending of the assessment year for which this waiver is sought. 3. The claimant(s) must fill in the date in paragraph 2 for the beginning of the assessment year for which this waiver is sought. 4. All claim and site names and Bureau of Land Management (BLM) serial numbers must be listed for the mining claims, mill sites, and tunnel sites for which the waiver is sought. 5. All owners of the mining claims, mill sites, and tunnel sites and their addresses must be given. 6. This waiver form must be signed by all the claimants or their designated agent, in original form. If an agent is designated, a notarized designation of agent, signed by all of the claimants with proper address given, must be submitted with this waiver. | <ol style="list-style-type: none"> 7. This form must be filed no later than September 1st for the upcoming assessment year in the BLM State Office where the mining claims or sites are recorded, or the waiver cannot be granted by the BLM. (Example: to obtain a waiver for the assessment year 2000, which begins at noon on September 1, 1999, you must qualify for and file for a waiver no later than September 1, 1999, in the proper BLM State Office). 8. For all mining claims which require assessment work, you must record an affidavit of labor on or before the December 30th immediately following the filing of this waiver. For all other mining claims or sites waived, you must record a notice of intent to hold on or before the December 30th immediately following the filing of this waiver. 9. Mill and tunnel sites may also be listed upon this waiver and be waived from payment of the maintenance fee. A notice of intent to hold for these sites is required to be filed by the December 30th following the filing of this waiver. |
|--|--|

NOTICE/BURDEN HOURS STATEMENT

The Privacy Act of 1974 *as amended*, and the regulation in 43 CFR 2.48(d) provide that you be furnished the following information in connection with the information required by this certification of waiver from rental fees.

AUTHORITY: 30 U.S.C. 28-28k; 43 U.S.C. 1201, 1457, 1740, and 1744; and 43 CFR 3830.

PRINCIPLE PURPOSE: This information is to be used to verify that the owner(s) (claimants) of a mining claim has complied with 30 U.S.C. 28f and is entitled to perform assessment work in lieu of paying the maintenance fee for the mining claims listed on this form.

ROUTINE USE: (1) Adjudication of the claimant(s) certification of waiver from paying the maintenance fee otherwise required by 30 U.S.C. 28f. (2) Disclosure may be made to appropriate Federal agencies when location is made within the agency's geographic area of responsibility. (3) Information from the record and/or the record will be transferred to the appropriate Federal, State, or local agency, or a member of the public in response to a specific request for pertinent information. (4) Information may also be provided to the Department of Justice or in a proceeding before a court or adjudicative body; or to Federal, State, local or foreign agencies when needed for enforcement of civil or criminal codes or applicable regulations concerning title rights upon the public land.

EFFECT OF NOT PROVIDING INFORMATION: Disclosure of this information is required by 30 U.S.C. 28f and 43 CFR Part 3830 for those qualified claimants wishing to take the small miner waiver allowed. Failure to supply the information required in this form to support the claimants certification of waiver from payment of the otherwise required maintenance fees will result in the waiver being disallowed and the mining claims subject to forfeiture by BLM under 30 U.S.C. 28i.

The Paperwork Reduction Act of 1995 requires us to inform you that:

This information is being collected to allow the BLM to determine if you qualify for a waiver from the payment of \$100 per mining claim or site maintenance fee established in 30 U.S.C. 28f and the implementing regulations at 43 CFR 3830. A response to this request is required in accordance with the statute to obtain your benefit.

BLM would like you to know that you do not have to respond to this, or any other, Federal agency-sponsored information collection unless it displays a currently valid OMB control number.

Public reporting burden for this form is estimated to average 20 minutes (.33 hours) per response, including time to review instructions, gathering and maintaining data, and completing and reviewing the form. Direct comments regarding this burden estimate, or any other aspect of this form, to the U.S. Department of the Interior, Bureau of Land Management, (1004-0114) Bureau Information Collection Clearance Officer (WO-630), Mail Stop 401 LS, 1849 C St., N.W., Washington, D.C. 20240.

FOR OFFICIAL USE ONLY

Customer Name Update Screen

System ID:MC

Name: CLARK CHARLES

Lookup

Proprietor #: 2280384

Renumber To:

Category: P - PRIVATE

Address: PO BOX 451

City: KINGMAN

State: AZ

Zip: 864020451

Address Updated
ENTERED INTO COMPUTER
AUG 27 2010

*8/27 - spoke w/ Donna Clark
3:20pm
PB*

Save

Save/Override DataFlux

Delete

Renumber

Customer details successfully saved for Customer Id 2280384

LR2000 Production

U.S. DEPARTMENT OF THE INTERIOR
BUREAU OF LAND MANAGEMENT



Mining Claims

- Case Recordation
- View
- Mining Claims**
- View/Update
- Mass Owner
- Mass Action
- Mass Remarks
- Status
- View
- LLD / Land
- View LLD
- Customer Name
- New
- View/Update
- Transaction Rpts
- Mass Upd Report
- MC CBS Export
- CBS Import Rpt
- Data Scan
- Case Scan
- Administration
- My Permissions
- Decode Tables

Last modified: 02/08/2010 12:17:34

Status: ACTIVE

Serial Number
AMC396376

- View
- Void
- Delete
- Copy

Serial Register Page

Case Header Details

Case Type	Claim Name	Commodity	Lead File Nr
384101	BOULDER CREEK LODE		AMC396376



Pulled for Extract	Extract Processed	Extract Status	PM Status
10/06/2009	11/13/2009	Extract Successful	PM Successful
Partial Geometry	Partial Case Land	Geometry Preserved	
No	No	No	

Update Header Details

Owner Details

Search Criteria: Search Column: Search

Proprietor Name(LFI)	Int Rel	Address	Address2	City	State	Zip
CLARK CHARLES	58	3565 E JOHN L AVE		KINGMAN	AZ	864092300

Update Customer Details # Customers: 1 Update Multiple Cases

Previous Address

Switch Screen

Land Description Details

Meridian: Township: Range: Section: Search Column: Search

Meridian	Twp	Range	Sec	NE	NW	SW	SE	Geo St	County	Office	SMA
14	0200N	0170W	010	X	X			AZ	MOHAVE	KINGMAN FIELD OFFICE	BUREAU OF LAND MGMT

Update Location Details # Locations: Update Multiple Cases

Function Keys	
Alt <-	Back
Alt ->	Forward
Alt-F2	Switch
Alt-F4	Close
Backspace	Back

Action Details

Search Criteria: Search Column: Search

	Date (mm/dd/yyyy)	Code	Action Taken	Action Remarks	Receipt Nr
1	01/20/2009	403	LOCATION DATE		
2	03/26/2009	395	RECORDATION NOTICE RECD	1	1893334
3	08/10/2009	483	SMALL MINER CERT FILED	2010	
4	02/04/2010	669	LAND STATUS CHECKED		
5	08/11/2009	481	NOTICE OF INTENT TO HOLD	2009	1976497

Update Action Details # Actions: 9 Update Multiple Cases

Remarks

Search Criteria: Search Column: Search

Line #	Remarks
---	No Data Found

Update Remarks # Remarks: 0 Update Multiple Cases

Top of Screen

From Charles Clark
POB 451
Kingman AZ 86402-0451
Mining Claim # AMC396376

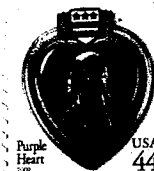

RECEIVED
BLM AZ STATE OFFICE
2010 AUG -2 P 12:30
PHOENIX, ARIZONA

Bureau of Land Management
Mine Claim Filings
1 North Central Ave
Phoenix AZ 85004-4427

8500482322

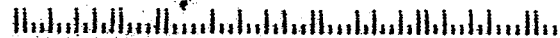

383

UNITED STATES DEPARTMENT OF THE INTERIOR
BUREAU OF LAND MANAGEMENT

AMC 396376

FORM APPROVED
OMB NO. 1004-0114
Expires: February 28, 2010

MAINTENANCE FEE WAIVER CERTIFICATION

Asst.

SEE INSTRUCTIONS ON REVERSE

1. This small miner waiver is filed for the assessment year beginning at noon on September 1, 2008 and ending at noon on September 1, 2009.
2. The undersigned and all related parties owned ten or fewer mining claims, mill, or tunnel sites located and maintained on Federal lands in the United States of America on September 1, 2009.
3. The undersigned have performed the assessment work required by law for each mining claim listed prior to filing this waiver and understand that by filing this form; an affidavit of assessment work must be recorded by the December 30th following the filing of this waiver.
4. The undersigned understand that if the assessment work obligation has not yet come due under 30 U.S.C. 28 (for those claims in their first assessment year only); a notice of intent to hold reciting this condition must be recorded by the December 30th following the filing of this waiver.
5. The undersigned understand that mill and tunnel sites may also be listed upon this waiver and be waived from payment of the maintenance fee; and that a notice of intent to hold for these sites is required to be recorded by the December 30th immediately following the filing of this waiver.
6. The undersigned understand and acknowledge that pursuant to 43 U.S.C. 1212 and 18 U.S.C. 1001; the filing or recording of a false, fictitious, or fraudulent document with the Bureau of Land Management may result in a fine of up to \$250,000, a prison term not to exceed five years, or both.
7. The mining claims, mill or tunnel sites for which this waiver from payment of the maintenance fees is requested are:

CLAIM OR SITE NAME	BLM RECORDATION SERIAL NUMBER
1. <u>Boulder Creek Lode Mine</u>	<u>AMC 396376 L</u>
2.	
3.	
4.	
5.	
6.	
7.	
8.	
9.	
10.	

RECEIVED
BLM AZ STATE OFFICE
2009 AUG 10 A 11:53
PHOENIX, ARIZONA

The owner(s) (claimants) of the above mining claims and sites are:

Charles Clark
(Owner's Name - Please Print)

3565 John L Ave Box 11
(Street or P.O. Box)

Kingman AZ 86401
(City) (State) (Zip Code)

Charles Clark
(Owner's Signature)

(Owner's Name - Please Print)

(Street or P.O. Box)

(City) (State) (Zip Code)

(Owner's Signature)

(Owner's Name - Please Print)

(Street or P.O. Box)

(City) (State) (Zip Code)

(Owner's Signature)



(Owner's Name - Please Print)

(Street or P.O. Box)

(Owner's Name - Please Print)

(Street or P.O. Box)

(Owner's Name - Please Print)

(Street or P.O. Box)

(Owner's Name - Please Print)

(Street or P.O. Box)

(Owner's Signature)

(City) _____
(State) _____
(Zip Code)

(Owner's Signature)

(City) _____
(State) _____
(Zip Code)

(Owner's Signature)

(City) _____
(State) _____
(Zip Code)

(Owner's Signature)

(City) _____
(State) _____
(Zip Code)

INSTRUCTIONS

1. This certification is made under the provisions of § 1744 of Title 43 and § 28-28k of Title 30 of the United States Code; and the regulations thereunder (43 CFR Part 3830).
2. The claimant(s) must fill in the dates in paragraph 1 for the beginning and ending of the assessment year for which this waiver is sought.
3. The claimant(s) must fill in the date in paragraph 2 for the beginning of the assessment year for which this waiver is sought.
4. All claim and site names and Bureau of Land Management (BLM) serial numbers must be listed for the mining claims, mill sites, and tunnel sites for which the waiver is sought.
5. All owners of the mining claims, mill sites, and tunnel sites and their addresses must be given.
6. This waiver form must be signed by all the claimants or their designated agent, in original form. If an agent is designated, a notarized designation of agent, signed by all of the claimants with proper address given, must be submitted with this waiver.
7. This form must be filed no later than September 1st for the upcoming assessment year in the BLM State Office where the mining claims or sites are recorded, or the waiver cannot be granted by the BLM. (Example: to obtain a waiver for the assessment year 2000, which begins at noon on September 1, 1999, you must qualify for and file for a waiver no later than September 1, 1999, in the proper BLM State Office).
8. For all mining claims which require assessment work, you must record an affidavit of labor on or before the December 30th immediately following the filing of this waiver. For all other mining claims or sites waived, you must record a notice of intent to hold on or before the December 30th immediately following the filing of this waiver.
9. Mill and tunnel sites may also be listed upon this waiver and be waived from payment of the maintenance fee. A notice of intent to hold for these sites is required to be filed by the December 30th following the filing of this waiver.

NOTICE/BURDEN HOURS STATEMENT

The Privacy Act of 1974, as amended, and the regulation in 43 CFR 2.48(d) provide that you be furnished the following information in connection with the information required by this certification of waiver from rental fees.

AUTHORITY: 30 U.S.C. 28-28k; 43 U.S.C. 1201, 1457, 1740, and 1744; and 43 CFR 3830.

PRINCIPLE PURPOSE: This information is to be used to verify that the owner(s) (claimants) of a mining claim has complied with 30 U.S.C. 28f and is entitled to perform assessment work in lieu of paying the maintenance fee for the mining claims listed on this form.

ROUTINE USE: (1) Adjudication of the claimant(s) certification of waiver from paying the maintenance fee otherwise required by 30 U.S.C. 28f. (2) Disclosure may be made to appropriate Federal agencies when location is made within the agency's geographic area of responsibility. (3) Information from the record and/or the record will be transferred to the appropriate Federal, State, or local agency, or a member of the public in response to a specific request for pertinent information. (4) Information may also be provided to the Department of Justice or in a proceeding before a court or adjudicative body; or to Federal, State, local or foreign agencies when needed for enforcement of civil or criminal codes or applicable regulations concerning title rights upon the public land.

EFFECT OF NOT PROVIDING INFORMATION: Disclosure of this information is required by 30 U.S.C. 28f and 43 CFR Part 3830 for those qualified claimants wishing to take the small miner waiver allowed. Failure to supply the information required in this form to support the claimants certification of waiver from payment of the otherwise required maintenance fees will result in the waiver being disallowed and the mining claims subject to forfeiture by BLM under 30 U.S.C. 28i.

The Paperwork Reduction Act of 1995 requires us to inform you that:

This information is being collected to allow the BLM to determine if you qualify for a waiver from the payment of \$100 per mining claim or site maintenance fee established in 30 U.S.C. 28f and the implementing regulations at 43 CFR 3830. A response to this request is required in accordance with the statute to obtain your benefit.

BLM would like you to know that you do not have to respond to this, or any other, Federal agency-sponsored information collection unless it displays a currently valid OMB control number.

Public reporting burden for this form is estimated to average 20 minutes (.33 hours) per response, including time to review instructions, gathering and maintaining data, and completing and reviewing the form. Direct comments regarding this burden estimate, or any other aspect of this form, to the U.S. Department of the Interior, Bureau of Land Management, (1004-0114) Bureau Information Collection Clearance Officer (WO-630), Mail Stop 401 LS, 1849 C St, N.W., Washington, DC. 20240.

FOR OFFICIAL USE ONLY

2

AMC 396376

B: 7556 P: 250

OFFICIAL RECORDS OF MOHAVE COUNTY CAROL MEIER, COUNTY RECORDER



08/07/2009 01:38 PM Fee: \$14.00 DOC TYPE: HOLD PAID BY: CHARLES CLARK

NOTICE OF INTENTION TO HOLD MINING CLAIMS/SITES

When Recorded Return Document to:

Charles Clark
3565 John L Ave Box 11
Kingman AZ 86401-0011

Ret:

RECEIVED
BLM AZ STATE OFFICE
2009 AUG 11 A 8:28
MOHAVE, ARIZONA
BLM Date Stamp

Check here if this is a change of address.
Telephone: 928-692-5570

E-mail Address hyderabad2@frontier.net.net

I (We) intend to hold the claims(s) and/or site(s) listed below for the calendar year 2009, and I (We) have filed or will file a Notice of Intent to Hold in the county where the claim (s) is located.

Reason for filing a Notice of Intent to Hold instead of an assessment work filing (check one):

- Maintenance fee was paid to maintain claim(s) during this assessment year.
- Mill or tunnel sites.
- Claim(s) was located during the current assessment year.
- BLM has deferred assessment work (attach copy of decision granting deferment, or pending petition for deferment including date petition was filed.)

Line No.	AMC NUMBER	CLAIM/SITE NAME	COUNTY RECORDER DATA (If available)	TWP	RNG	SEC
1	396376	Boulder Creek Lode Mine	B: 7556 P: 250	20 N	17 W	10
2						
3						
4						
5						
6						
7						
8						
9						
10						



NOTICE OF INTENTION TO HOLD MINING CLAIMS/SITES
page 2

BLM
Date
Stamp

1. State of Arizona, County of Mohave

2. I (Name) Charles Clark

3. Reside at (Address) 3565 John L Ave, Box 11

City Kingman County Mohave State AZ zip 86401 being duly sworn, depose and say that I am a citizen of the United States, more than eighteen years of age, that all of the facts set forth in this notice, subject to the provisions and penalties of 18 U.S.C. 1001 pertaining to the filing of false, fictitious, or fraudulent statements with the United States, are true and correct according to the best of my knowledge, information and belief.

4. Owner's name and address (if not shown in Items 1-3 above). _____

5. Dated: 08/01/09 Signature: Charles Clark

Bureau of Land Management
Arizona State Office
www.az.blm.gov

No. of Claims: 1 x \$10 = 10
Check No: 8755 Init. CMC
Receipt No.: 1976497
For BLM Use Only

United States Department of the Interior

Bureau of Land Management

BUSINESS & SUPPORT SVCS DIV

ONE N CENTRAL AVE SUITE 800

PHOENIX, AZ 85004 -4427

Phone: (602) 417-9200

Receipt

No:

1976497

Transaction #: 2040475	
Date of Transaction: 08/13/2009	
CUSTOMER:	CHARLES CLARK 3565 E JOHN L AVE LOT 11 KINGMAN, AZ 86409-2380 US

LINE #	QTY	DESCRIPTION	REMARKS	UNIT PRICE	TOTAL
1	1.00	LOCATABLE MINERALS / MINING CLAIMS-NOT NEW-UNADJUD, ONE AUTH NO. ONLY / MINING CLAIM MONEY RECEIVED CASES: AMC396376/\$10.00	NOI 2009/1	- n/a -	10.00
TOTAL:					\$10.00

PAYMENT INFORMATION					
1	AMOUNT:	10.00	POSTMARKED:	08/08/2009	
	TYPE:	CHECK	RECEIVED:	08/11/2009	
	CHECK NO:	50313818755			
	NAME:	CLARK, CHARLES 3565 E JOHN L AVE LOT 11 KINGMAN AZ 86409-2380 US			

REMARKS

This receipt was generated by the automated BLM Collections and Billing System and is a paper representation of a portion of the official electronic record contained therein.

NOTICE!!

These documents have been scanned!

Do not place un-scanned documents beneath this notice!

Do not remove this notice from this file!

GPO Jacket No. 560-102
Print Order 61540
Rise Business Services, LLC
Job=AZ15 5/22/2019



Box Number= AZ15076



Claim Begin-End: AMC396376-AMC396376

5 Miscellaneous



AZ15076-14

AMC396025-AMC396393

**NO
DOCUMENTS
FOUND**

NO DOCUMENTS FOUND
NO DOCUMENTS FOUND

NOTICE!!

These documents have been scanned!

Do not place un-scanned documents beneath this notice!

Do not remove this notice from this file!

GPO Jacket No. 560-102
Print Order 61540
Rise Business Services, LLC
Job=AZ15 5/22/2019



Box Number= AZ15076



Claim Begin-End: AMC396376-AMC396376

6 Location Notices-Amendments and Supporting Documents



AZ15076-14 AMC396025-AMC396393

MINING CLAIM STATUS REPORT

MTP CHECKED BY _____

DATA ENTRY _____

GEO CHECKED BY _____

LEAD SERIAL NO. AMC 396376 THROUGH AMC

# <u>1</u> LODE	LOCATION FEE @ \$30 =	\$ <u>30.00</u>
# _____ PLACER	PROCESSING FEE @ \$15 =	\$ <u>15.00</u>
# _____ ASSOCIATION PL	MAINTENANCE FEE @ \$125 =	\$ <u>125.00</u>
# _____ MILL SITE	OVERAGE	\$ _____
# _____ TUNNEL SITE	SHORTAGE	\$ _____
	OTHER FEES	\$ _____
ENOUGH LOCATORS	TOTAL	\$ <u>170.00</u>
YES [] NO []		

OVER-THE-COUNTER [] MAIL TIMELY FILED: YES NO []

LEGAL DESCRIPTION: T 20N R 17W SEC 10

T _____ R _____ SEC _____

T _____ R _____ SEC _____

T _____ R _____ SEC _____

BLM [] FOREST SERVICE [] _____ SUBJ TO PL 359: YES [] NO []

WILDERNESS AREA: NO [] YES [] _____

SPLIT ESTATE: SX [] PX [] SRHA [] OTHER [] _____ N/A []
PROPER NOTICE FILED IF LOCATED ON SRHA LANDS-YES [] NO [] N/A []

RECONVEYED MINERALS ON BLM LANDS REQUIRE OPENING ORDERS FROM 1944 TO 1993. OPEN TO ENTRY ON: _____ N/A []

COMMENTS/STATUS: VOID [] PARTIALLY VOID [] PVT MINERALS []
WITHDRAWN LANDS [] OTHER [] _____

Claimant acknowledges that portions of the following claim(s) site(s) may be void or voidable. _____

Signature of claimant _____

FINAL ADJUDICATION TS DATE 2/14/2010

AMC 396376

B: 7394 P: 64

OFFICIAL RECORDS OF MOHAVE COUNTY CAROL MEIER, COUNTY RECORDER



01/30/2009 10:17 AM Fee: \$14.00 DOC TYPE: MINE PAID BY: CHARLES CLARK

2E

LOCATION NOTICE FOR LODE MINING CLAIM

NOTICE IS HEREBY GIVEN that the Boulder Creek Lode Mine lode mining claim has been located by Charles Clark whose current mailing address is 3565 John L Ave, Box 11 Kingman AZ 86401-0011

RECEIVED BLM AZ STATE OFFICE 2009 MAR 26 A 8:37 PHOENIX, ARIZONA BLM Date Stamp

Ret

The general course of this claim is East and it is situated in Mohave County, Arizona. This claim is 1500 feet in length and 600 feet in width. This claim runs from the location monument on which this location notice is posted approximately 750 feet in a westerly direction to the west end line and 750 feet in a easterly direction to the east end line. This claim is marked by six monuments, one at each corner and one at the center of each end line of the claim.

The location monument on which this notice is posted is situated within Section 10, Township 20 N, Range 17 W, Gila Salt River Base and Meridian, Arizona and this claim encompasses portions of the following quarter section (s), section (s), Township (s) and Range (s) W 1/2 SENW 1/4 SWNE 1/4

Gila Salt River Base and Meridian, Arizona.

The locality of this claim with reference to some natural object or permanent monument and additional information (if any) concerning its locality are as follows: between pipeline roads. Discovery monument marker located near mine entrance.

DATED AND POSTED on the ground this 20th day of January, 2009.

LOCATOR (s) Charles Clark

Form MCF100 Revised July 2005

AMC 396376

MINING CLAIM MAP

Lode (X) Placer ()

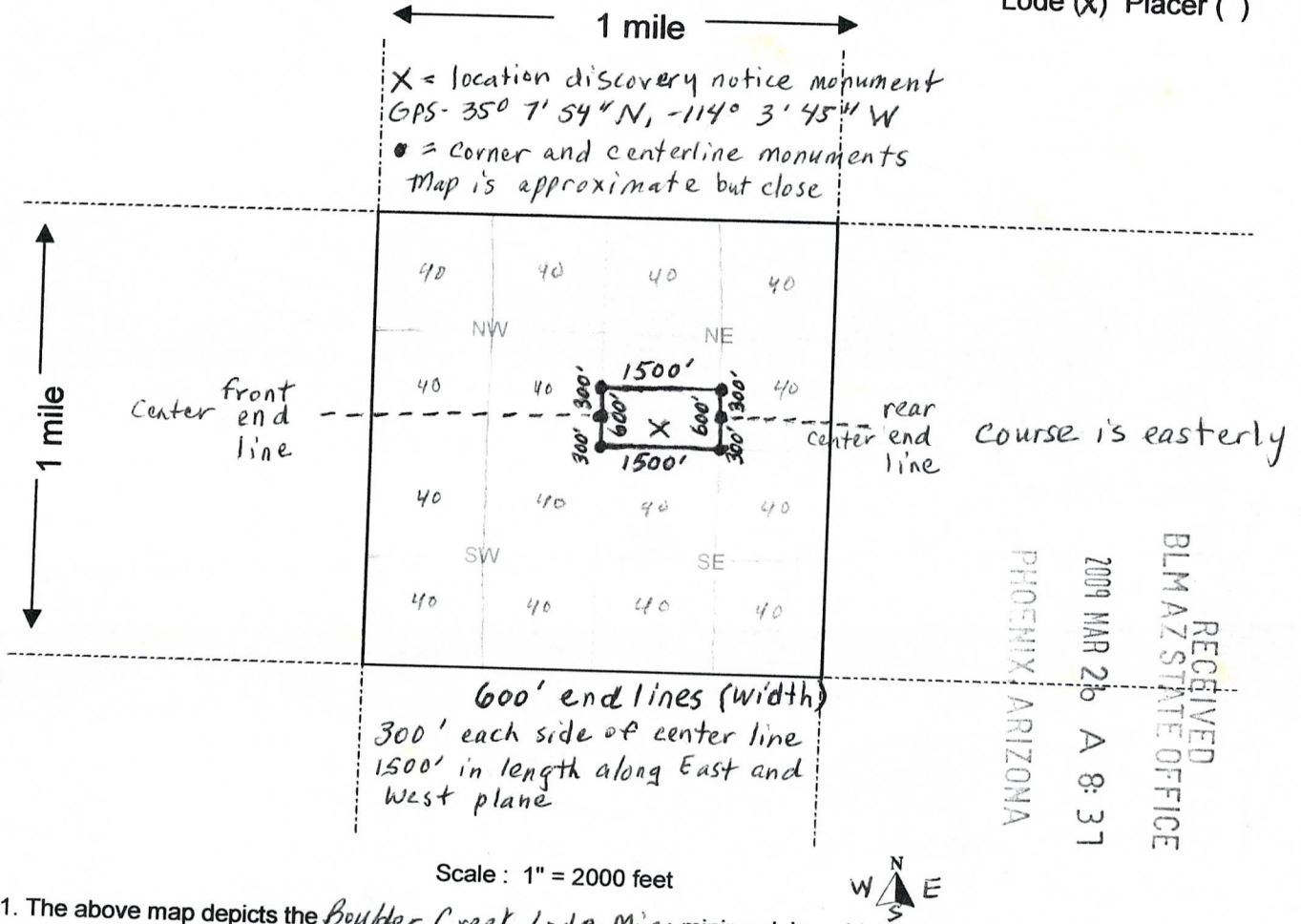

1. The above map depicts the Boulder Creek Lode Mine mining claim, which is located in Section (s) 10, Township 20 N, Range 17 W, Gila and Salt River Base and Meridian, Mohave County, Arizona.
2. The type of corner and location monuments used are as follows: 4' x 4" x 4" wooden posts
plague sign used for discovery location monument at mine entrance
3. The bearings and distances in degrees and feet between claim corners are as depicted on the map.

Form MCF100a
 Revised July 2005

MAINTENANCE FEE PAYMENT

Claimant Name: Charles Clark
 Address: 3565 John L Ave Box 11
 City: Kingman State: AZ Zip: 86401
 Telephone: 928-692-5570
 E-mail address: hyderbad2@frontier.net
 Signature: Charles Clark

Check here if this is a change of address.

RECEIVED
 BLM AZ STATE OFFICE
 PHOENIX, ARIZONA
 2009 MAR 26 A 8:37
 BLM
 Date
 Stamp

LINE NO.	AMC NUMBER	CLAIM/SITE NAME	COUNTY RECORDER DATA (If available)	TWP	RNG	SEC
1		Boulder Creek Lode Mine		20N	17W	10
2						
3						
4						
5						
6						
7						
8						
9						
10						

List additional claims on Form MCF114.

Bureau of Land Management
Arizona State Office
www.az.blm.gov

No. of Claims: _____ x \$125 = _____
 Check No: _____ Init. _____
 Receipt No.: _____
For BLM Use Only

Form: MCF112
 Revised July 2005

This form is available from the **Arizona Department of Mines and Mineral Resources** and may be reproduced.

AMC 396376

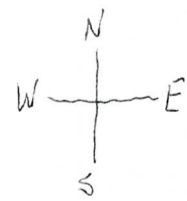

Boulder Creek Lode Mine (Map 2)

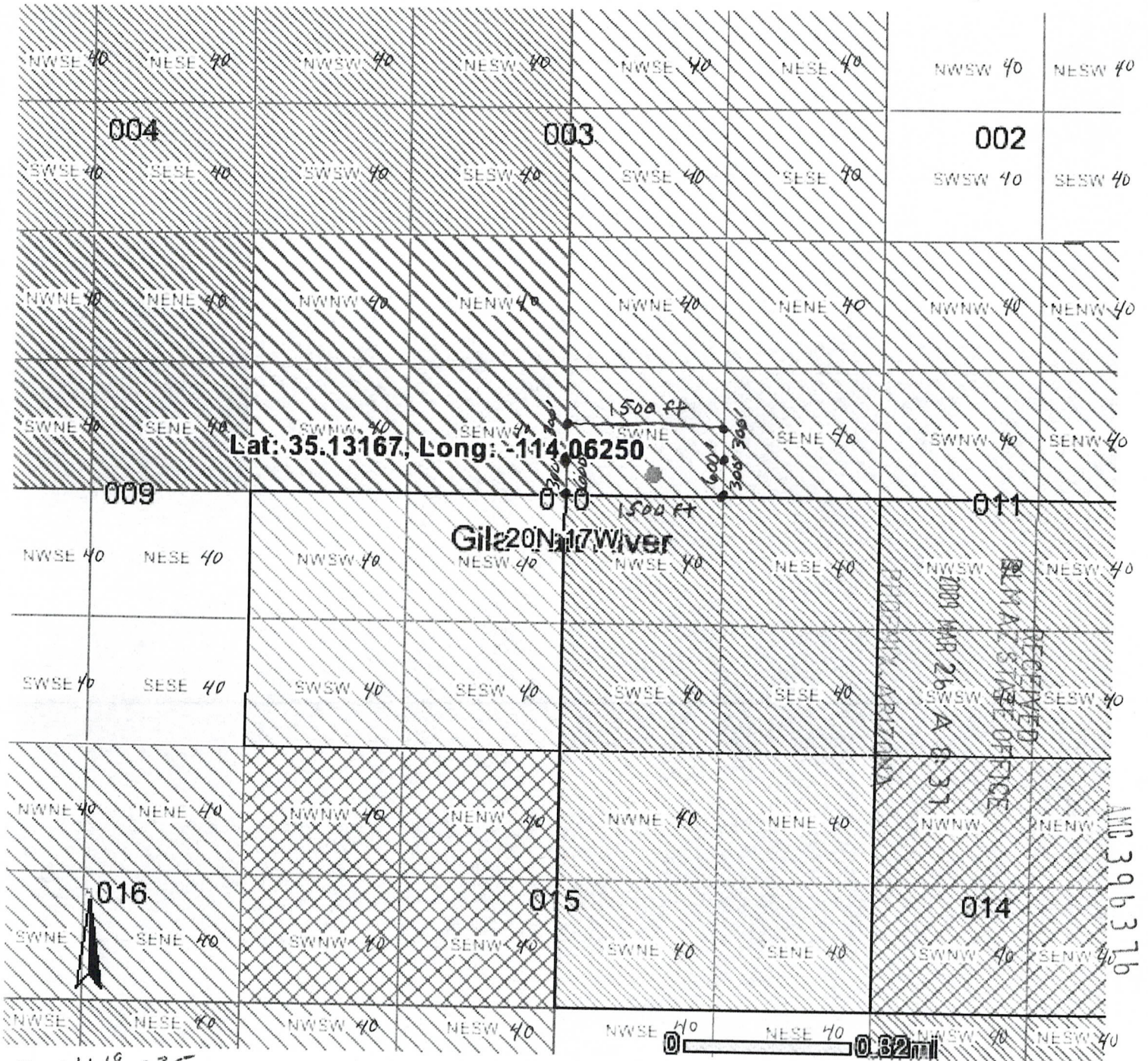

Map: 1:18,035 Coordinates: Subdivisions, Divisions, Sections, Townships, Meridians

/// blue lines = abandoned or closed claims

/// red lines = open or active claims

red dot is location marker at mine entrance

35° 7' 54" N, 119° 3' 45" W
 UTM - N. 3891595.07, E. 767661.66
 ZONE 11S
 T20N R17W Sec 10

1/20/2009

No warranty is made by the BLM for the use of the data for purposes not intended by the BLM.

Source = GeoCommunicator Mapping Website

Boulder Creek Lode Mine

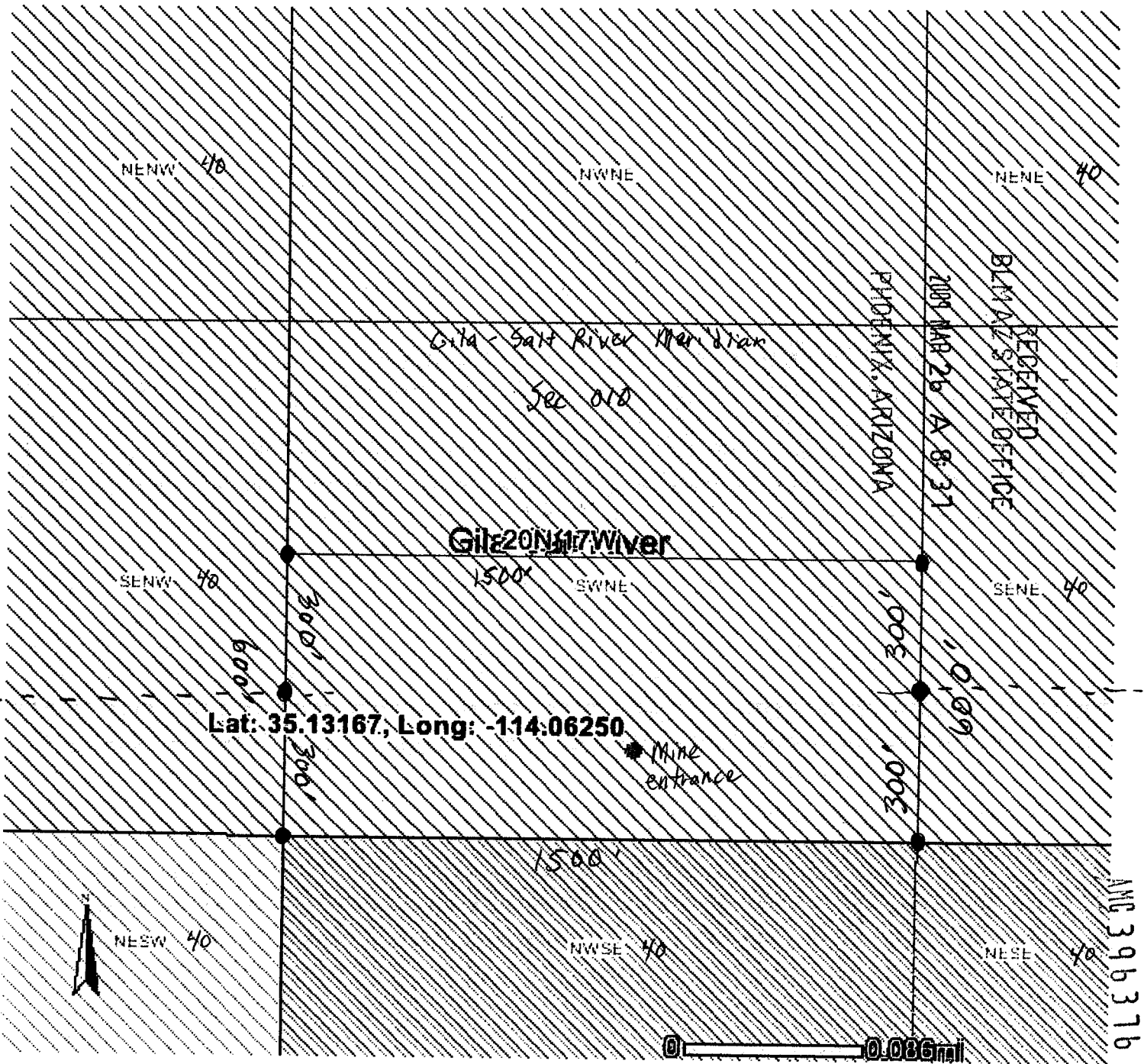

Coordinates: Subdivision, Division, Section, Township, Meridian

/// blue lines = abandoned or closed claims

DMS: 35° 7' 54" N
-114° 3' 45" W

/// red lines = open or active claims

UTM: N: 3891595.07, E: 767661.66
ZONE 11S

● red dot = discovery location notice monument

1/20/2009

No warranty is made by the BLM for the use of the data for purposes not intended by the BLM.

Source = GeoCommunicator Mapping Website

Input Parameters for Geographic Report with Land

System Id = CR

Admin State = AZ

Geo State =

Casetype Begins With

Case Disp Txt = AUTHORIZED

Mer Twp Rng =

Section =

Mtrs = 14 0200N 0170W 010

Commodity =

Commodity Txt =

Pending Org =

Pend Org Decode =

Total Rows Returned: 12

UNITED STATES DEPARTMENT OF INTERIOR
 BUREAU OF LAND MANAGEMENT
 GEOGRAPHIC REPORT WITH LAND
 Sorted by Serial Number

Adm State: AZ

Serial Number: AZA 002938
 Total Case Acres: 34.050

<u>Casetype</u>	<u>Case Disp</u>				<u>Sect</u>	<u>Sur Typ</u>	<u>Sur Num</u>	<u>Suff</u>	<u>Subdivision</u>	<u>Act Pend</u>
288100	AUTHORIZED	14	0200N	0170W	010	ALIQ			N2NE,SWNE,SENW,N2SW;	

Serial Number: AZA 010120
 Total Case Acres: 5.933

<u>Casetype</u>	<u>Case Disp</u>				<u>Sect</u>	<u>Sur Typ</u>	<u>Sur Num</u>	<u>Suff</u>	<u>Subdivision</u>	<u>Act Pend</u>
285003	AUTHORIZED	14	0200N	0170W	010	ALIQ			N2NE,SWNE;	Y
						MNR		1	NENWSE,NWNESE;	Y
								1		
								2	SWSWSENE;	Y
								2		

Serial Number: AZA 010163
 Total Case Acres: 1.800

<u>Casetype</u>	<u>Case Disp</u>				<u>Sect</u>	<u>Sur Typ</u>	<u>Sur Num</u>	<u>Suff</u>	<u>Subdivision</u>	<u>Act Pend</u>
286203	AUTHORIZED	14	0200N	0170W	010	ALIQ			N2S2;	

Serial Number: AZA 010203
 Total Case Acres: 1.800

<u>Casetype</u>	<u>Case Disp</u>				<u>Sect</u>	<u>Sur Typ</u>	<u>Sur Num</u>	<u>Suff</u>	<u>Subdivision</u>	<u>Act Pend</u>
281001	AUTHORIZED	14	0200N	0170W	010	ALIQ			S2;	Y

Serial Number: AZA 016833
 Total Case Acres: 4.930

<u>Casetype</u>	<u>Case Disp</u>				<u>Sect</u>	<u>Sur Typ</u>	<u>Sur Num</u>	<u>Suff</u>	<u>Subdivision</u>	<u>Act Pend</u>
285003	AUTHORIZED	14	0200N	0170W	010	ALIQ			W2NE,NW;	

RUN TIME: 03:29 PM

UNITED STATES DEPARTMENT OF INTERIOR
BUREAU OF LAND MANAGEMENT
GEOGRAPHIC REPORT WITH LAND
Sorted by Serial Number

RUN DATE: 05/05/2009

Page 2 of 2

Adm State: AZ

Serial Number: AZA 030690

Total Case Acres: 127.850

<u>Casetype</u>	<u>Case Disp</u>				<u>Sect</u>	<u>Sur Typ</u>	<u>Sur Num</u>	<u>Suff</u>	<u>Subdivision</u>	<u>Act Pend</u>
285003	AUTHORIZED	14	0200N	0170W	010	ALIQ			NWNENW,W2NW,W2SW;	

Serial Number: AZA 031717

Total Case Acres: 9.906

<u>Casetype</u>	<u>Case Disp</u>				<u>Sect</u>	<u>Sur Typ</u>	<u>Sur Num</u>	<u>Suff</u>	<u>Subdivision</u>	<u>Act Pend</u>
285003	AUTHORIZED	14	0200N	0170W	010	ALIQ			SW;	

Serial Number: AZA 033547

Total Case Acres: 19,051.340

<u>Casetype</u>	<u>Case Disp</u>				<u>Sect</u>	<u>Sur Typ</u>	<u>Sur Num</u>	<u>Suff</u>	<u>Subdivision</u>	<u>Act Pend</u>
285003	AUTHORIZED	14	0200N	0170W	010	ALIQ			ALL;	

Serial Number: AZAR 0017080

Total Case Acres: 148.037

<u>Casetype</u>	<u>Case Disp</u>				<u>Sect</u>	<u>Sur Typ</u>	<u>Sur Num</u>	<u>Suff</u>	<u>Subdivision</u>	<u>Act Pend</u>
288100	AUTHORIZED	14	0200N	0170W	010	ALIQ			N2S2,S2SW;	

Serial Number: AZAR 0023662

Total Case Acres: 164.600

<u>Casetype</u>	<u>Case Disp</u>				<u>Sect</u>	<u>Sur Typ</u>	<u>Sur Num</u>	<u>Suff</u>	<u>Subdivision</u>	<u>Act Pend</u>
288100	AUTHORIZED	14	0200N	0170W	010	ALIQ			NE,SENW,N2SW,SWSW;	

